

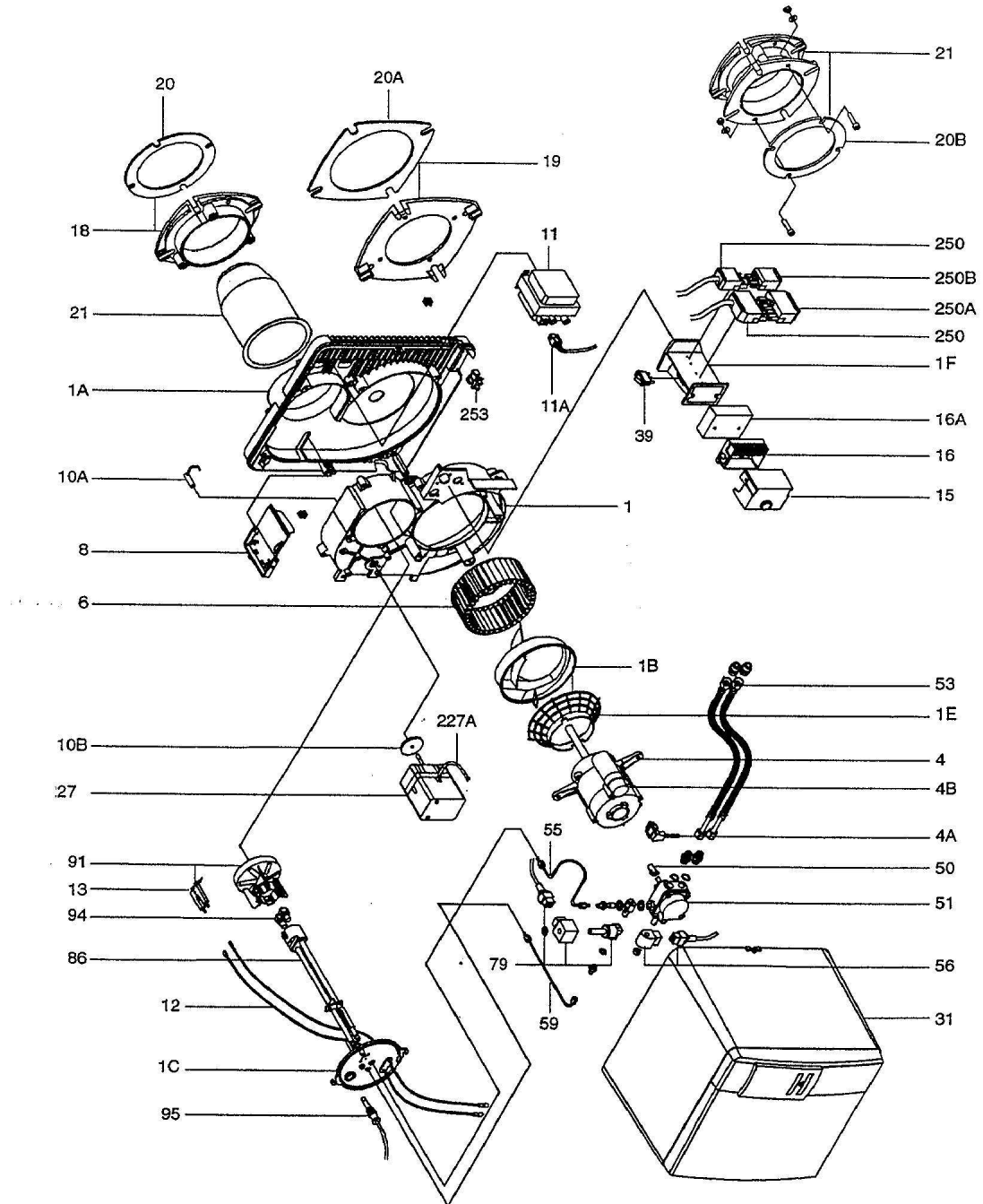





BRULEUR FIOUL TYPE 18 / 28 2A



1575

BRULEUR CF 18 2A

| Réf. | Référence | Description                   | Qté | Tarif             | Substitué | Tarif Sub. | Remarques |
|------|-----------|-------------------------------|-----|-------------------|-----------|------------|-----------|
| 0    | S5808418  | POCHETTE ACCESSOIRES FIOUL    | 1   | Nous consulter... |           |            | ⊘         |
| 0    | S5808349  | POCHETTE FIXATION BRULEUR     | 1   | 69,90 €           |           |            |           |
| 0    | S5808418  | POCHETTE VISSERIE             | 1   | Nous consulter... |           |            | ⊘         |
| 0    | S5808418  | ENS.BANJO + VIS CREUSE        | 1   | Nous consulter... |           |            | ⊘         |
| 0    | S5003508  | FILTRE 25MM(3715735)          | 1   | Nous consulter... |           |            | ⊘         |
| 0    | S5832761  | FILTRE POMPE AN/S 3715735     | 1   | Nous consulter... |           |            | ⊘         |
| 0    | S5855966  | BOBINE220V&CONNECT VE131&14   | 1   | Nous consulter... |           |            | ⊘         |
| 1    | S5808415  | DEMI VOLUTE ARRIERE COMPLETE  | 1   | Nous consulter... |           |            | ⊘         |
| 1A   | S5808415  | DEMI VOLUTE AVANT COMPLETE    | 1   | Nous consulter... |           |            | ⊘         |
| 1B   | S5808415  | ENS.OEILLARD + GRILLE         | 1   | Nous consulter... |           |            | ⊘         |
| 1C   | S5808418  | PLAQUE ARRIERE COMPLETE 2A    | 1   | Nous consulter... |           |            | ⊘         |
| 1E   | S5811931  | GRILLE D'ASPIRATION           | 1   | Nous consulter... |           |            | ⊘         |
| 1F   | S5808415  | SUPPORT BOITE DE CONTROLE     | 1   | Nous consulter... |           |            | ⊘         |
| 4    | S5808415  | MOTEUR AEG 250W               | 1   | 718,00 €          |           |            |           |
| 4A   | S5851849  | CABLE D'ALIMENTATION MOTEUR   | 1   | 38,70 €           |           |            |           |
| 4B   | S5820987  | CONDENSATEUR 8MF MOTEUR       | 1   | Nous consulter... |           |            | ⊘         |
| 6    | S5840994  | TURBINE 160X62 RE + VIS       | 1   | 185,00 €          |           |            |           |
| 8    | S5808415  | VOLET D'AIR                   | 1   | Nous consulter... |           |            | ⊘         |
| 10A  | S5808419  | MANETON COMMANDE VOLET D'AIR  | 1   | Nous consulter... |           |            | ⊘         |
| 10B  | S5808416  | DISQUE REPERAGE VOLET D'AIR   | 1   | Nous consulter... |           |            | ⊘         |
| 11   | S5850422  | TRANSFO ZM20/10 ENR 4022711   | 1   | Nous consulter... |           |            | ⊘         |
| 11   | S5808415  | TRANSFORMATEUR                | 1   | Nous consulter... |           |            | ⊘         |
| 11A  | S5808318  | CABLE RACCORD TRANSFORMATI    | 1   | 40,00 €           |           |            |           |
| 12   | S5808417  | FILS H.T 18/28 "N" (LA PAIRE) | 1   | 79,20 €           |           |            |           |
| 12   | S5808417  | FILS HT BUSE GL1 (LA PAIRE)   | 1   | 68,10 €           |           |            |           |
| 12   | S5808417  | FILS H.T 18/28 L646mm         | 1   | 42,00 €           |           |            |           |
| 13   | S5825418  | BLOC ELECTRODE 18/28 2A       | 1   | 36,20 €           |           |            |           |
| 15   | S5003674  | BLOC ACTIF LOA 24 (171B27)    | 1   | 243,00 €          |           |            |           |
| 16   | S5808416  | SOCLE AGK11+PASSE CABLES AG   | 1   | 131,00 €          |           |            |           |
| 16A  | S5853981  | REHAUSSE AGK 21               | 1   | 31,50 €           |           |            |           |
| 18   | S5808417  | BRIDE FIXATION BRULEUR        | 1   | 279,00 €          |           |            |           |
| 19   | S5808425  | CONTRE BRIDE COMPLETE         | 1   | Nous consulter... |           |            | ⊘         |
| 20   | S5839009  | JOINT D'ETANCHEITE            | 1   | Nous consulter... |           |            | ⊘         |
| 20   | S5839009  | JOINT DE FACADE 18/28         | 1   | 26,60 €           |           |            |           |
| 20A  | S5839008  | JOINT ETANCHEITE 230X230      | 1   | 23,80 €           |           |            |           |
| 20B  | S5839010  | JOINT ENTRETOISE BRIDE        | 1   | 25,70 €           |           |            |           |
| 21   | S5811932  | TUYERE TYPE 18 GL1            | 1   | Nous consulter... |           |            | ⊘         |
| 21   | S5808423  | BRIDE ENTRETOISE 18/28        | 1   | 390,00 €          |           |            |           |
| 21   | S5811932  | TUYERE TYPE 18 ML             | 1   | Nous consulter... |           |            | ⊘         |
| 21   | S5811931  | TUYERE TYPE 18 N L=190        | 1   | Nous consulter... |           |            | ⊘         |
| 31   | S5808417  | CAPOT CHAPPEE                 | 1   | Nous consulter... |           |            | ⊘         |
| 39   | S5858999  | INTERRUPTEUR INVERSEUR        | 1   | Nous consulter... |           |            | ⊘         |
| 50   | S5840993  | ACCOUPLLEMENT AEG 881 SAM4    | 1   | 6,60 €            |           |            |           |
| 51   | S5808416  | POMPE FIOUL AS57C             | 1   | Nous consulter... |           |            | ⊘         |
| 53   | S5808416  | FLEXIBLES (LA PAIRE)          | 1   | Nous consulter... |           |            | ⊘         |
| 55   | S5871667  | TUBULURE POMPE A LIGNE 1ERE   | 1   | 26,20 €           |           |            |           |
| 56   | S5832761  | ELECTROV. 220V CPLT POMPE AS  | 1   | 83,70 €           |           |            |           |
| 59   | S5871666  | TUBULURE V2F A LIGNE 2EME A   | 1   | 25,60 €           |           |            |           |
| 79   | S5855974  | ELECTROVANNE VE 140-2IRZ+CAB  | 1   | Nous consulter... |           |            | ⊘         |

|      |          |                                |   |                   |   |
|------|----------|--------------------------------|---|-------------------|---|
| 86   | S5808418 | LIGNE 2A BUSE ML               | 1 | 574,00 €          |   |
| 86   | S5808418 | LIGNE 2A BUSE GL1              | 1 | Nous consulter... |  |
| 86   | S5808418 | LIGNE TYP.18/28 2A "N"         | 1 | Nous consulter... |  |
| 91   | S5808418 | STABILO COMPLET 18 2A          | 1 | 351,00 €          |   |
| 95   | S5853975 | CELLULE QRB1A A048B70B         | 1 | Nous consulter... |  |
| 227  | S5856938 | MOTEUR CONNECTRON LKS 130.0    | 1 | 417,00 €          |   |
| 227  | S5856941 | SERVOMOTEUR LKS 120-05 B5-5 S  | 1 | Nous consulter... |  |
| 227A | S5808419 | CABLE CONNECTRON COMPLET       | 1 | 62,70 €           |   |
| 250  | S5808416 | CONNECTEUR FEMELLE 7 BROCHES C | 1 | 108,00 €          |   |
| 250A | S5858994 | CONNECTEUR MALE 7 BROCHES C    | 1 | 15,60 €           |   |
| 250B | S5858994 | CONNECTEUR MALE 4 BROCHES C    | 1 | 48,80 €           |   |
| 253  | S5808415 | SERRE CABLES COMPLET           | 1 | Nous consulter... |  |