

		PIECES DE RECHANGE					
UN CHAUFFAGE D'AVANCE BAXI France - 157, Avenue Charles Floquet - 93158 Le Blanc Mesnil Cedex - Téléphone 33 (0)1 45 91 56 00 - Télécopie 33 (0)1 45 91 59 00							
N° 2389		INITIA MAX 2.24 FF					
ENSEMBLE CHAUDIERE							
REP	DESIGNATIONS	PIECES COMMUNES		PIECES SPECIFIQUES			
		Qté	Code	Qté	Qté	Qté	Qté
-1	JOINT POUR ALLUMAUR NAC SIT ( x3 )	1	SX5407980				
1	CHASSIS MONTANT VERTICAL	1	SX5653140				
2	PANNEAU COTE GAUCHE H = 76	1	SX5653630				
3	PANNEAU COTE DROIT H = 76	1	SX5653620				
4	PANNEAU AVANT FI	1	SX5113430				
5	TRAVERSE ARRIERE SUPERIEURE	1	SX5110290				
6	TRAVERSE ARRIERE INFERIEURE	1	SX5111710				
8	TUBE SILICONE PRESSOSTAT ( x4 )	1	SX5408080				
9	DIAPHRAGME	1	SX5108700				
10	RACCORDEMENT VENTOUSE	1	SX5207060				
11	JOINT VENTOUSE CAOUTCHOUC	1	SX5407890				
12	OBTURATEUR	1	SX5108690				
13	JOINT OBTURATEUR CAOUTCHOUC ( x3 )	1	SX5407400				
15	JOINT SORTIE EXTRACTEUR	1	SX0600530				
17	COUDE	1	SX5211090				
18	VENTURI	1	SX5407050				
21	JOINT TUBE VASE EXPANSION ( x3 )	1	SX5402050				
22	EXTRACTEUR 1V MVL RLG 108	1	SX5653850				
23	PRESSOSTAT HONEYWELL	1	SX5629560				
24	TUBE SILICONE VANNE GAZ 4,5x8 L 300	1	SX5407930				
25	HOTTE D'EVACUATION DES FUMEEES	1	SX5653170				
27	CHAMBRE ETANCHE	1	SX5653780	==>B511			Non Interch.
27	CHAMBRE ETANCHE	1	SX0618840	B510==>			
28	PANNEAU ISOLANT LATERAL	1	SX5213160				
29	PANNEAU ISOLANT ARRIERE	1	SX5213290				
30	PANNEAU ISOLANT AVANT	1	SX5213340				
31	PANNEAU AVANT CHAMBRE COMBUST.	1	SX5111840				
32	ECHANGEUR PRINCIPAL	1	SX0603280				
32	ECHANGEUR PRINCIPAL 23 KW	1	SX5632470				
33	JOINT O RING 22x3 EPDM ( x3 )	1	SX5403130				
34	CLIP FIXATION ECHANGEUR PRIMAIRE	1	SX5112510				
35	VASE EXPANSION MINI ACCUMULATION	1	SX5658420				
37	PANNEAU AVANT CHAMBRE ETANCHE	1	SX5653710				
38	JOINT HUBLLOT ( x3 )	1	SX5401610				
39	HUBLLOT	1	SX5203930				
40	COUVERCLE HUBLLOT	1	SX5103360				
41	BRULEUR 12 BECS	1	SX5653310				
42	ELEMENT BRULEUR	1	SX5604090				
43	NOURRICE PORTE INJ.12 T. D. 1,28 ( G.N )	1	SX0605850				
43	NOURRICE PORTE INJ.12 T. D. 0,77 ( GPL )	1	SX0605990				

 <b>PIECES DE RECHANGE</b>							
<small>BAXI France - 157, Avenue Charles Floquet - 93158 Le Blanc Mesnil Cedex - Téléphone 33 (0)1 45 91 58 00 - Télécopie 33 (0)1 45 91 58 90</small>							
<b>N° 2389</b>	<b>INITIA MAX 2.24 FF</b>						
<b>ENSEMBLE CHAUDIERE</b>							
REP	DESIGNATIONS	PIECES COMMUNES		PIECES SPECIFIQUES			
		Qté	Code	Qté	Qté	Qté	Qté
44	KIT INJECTEUR NAT. D. 1,28	1	SX0608430				
44	KIT INJECTEUR GPL D. 0,77	1	SX0608450				
45	JOINT NOURRICE ( x3 )	1	SX5407940				
46	RACCORD NOURRICE	1	SX5657180				
47	JOINT NOURRICE / CAISSON	1	SX5407810				
49	BOUCHON RACCORDEMENT VENTOUSE	1	SX5207070				
59	CABLE ELECTRODE ALLUMAGE ( x2 )	1	SX8419050				
61	PROTECTION ELECTRODE ( x3 )	1	SX5407830				
62	RACCORD PRISE DE PRESSION	1	SX5643090	====>B510			Non Interch.
62	PRISE DE PRESSION FF	1	SX5409570	B511====>			
63	ELECTRODE ALLUMAGE ( x4 )	1	SX8422570				
70	TUBE POMPE ECHANGEUR	1	SX5653250				
72	POMPE GRUNDFOS 15/50	1	SX5655200				
73	DEGAZEUR	1	SX0607290				
74	JOINT O RING 14x1,78 DEGAZEUR ( x3 )	1	SX5406360				
75	JOINT TUBE / CAISSON ( x3 )	1	SX5404670				
76	ECHANGEUR SANITAIRE 22 PLAQUES	1	SX5652190				
80	GROUPE ENTREE SANIT / RETOUR CHAUFF.	1	SX5659040				
82	VENTURI ECS	1	SX5630170				
83	LIMITEUR DEBIT SANITAIRE 8 L/MN	1	SX5629240				
84	FILTRE SANITAIRE ( x3 )	1	SX5111180				
85	JOINT O RING FILTRE SANIT. ( x3 )	1	SX5405350				
87	ELEMENT DE CONNEXION POMPE	1	SX5210710				
90	ROBINET DE REMPLISSAGE	1	SX5630180				
91	ROBINET DE VIDANGE	1	SX5652030				
92	SOUPAPE DE SECURITE 3 BARS	1	SX5653690				
96	TUBE PRESSION	1	SX5658290				
97	TUBE PRESSION	1	SX5658300				
98	TUBE BY PASS	1	SX5658280				
99	CLIP TDUBE BY PASS	1	SX5108130				
102	VANNE 3 VOIES	1	SX5659470				
103	PRESSOSTAT SANITAIRE	1	SX5652130				
108	VIS M4x12	1	SX8101420				
109	JOINT ( x3 )	1	SX5207810				
112	MEMBRANE SECU. DEBIT D'EAU ( x3 )	1	SX5405960				
114	JOINT O RING ( x3 )	1	SX5403820				
117	BOUCHON AVANT	1	SX5646180				
118	RESSORT BY PASS	1	SX8380520				
120	BOUCHON AVANT GROUPE	1	SX5646190				
122	JOINT O RING FILTRE SANIT. ( x3 )	1	SX5405370				

 <b>PIECES DE RECHANGE</b>							
<small>BAXI France - 157, Avenue Charles Floquet - 93158 La Blanc Mesnil Cedex - Téléphone 33 (0)1 45 91 56 00 - Télécopie 33 (0)1 45 91 59 90</small>							
<b>N° 2389</b>	<b>INITIA MAX 2.24 FF</b>						
<b>ENSEMBLE CHAUDIERE</b>							
REP	DESIGNATIONS	PIECES COMMUNES		PIECES SPECIFIQUES			
		Qté	Code	Qté	Qté	Qté	Qté
131	SONDE CTN	1	SX8433090				
131	SONDE CTN	1	SX8434820				
132	JOINT SONDE CTN SANITAIRE ( x3 )	1	SX5402830				
134	DIAPHRAGME GAZ 4,7 MM	1	SX5211170				
135	SECURITE DE SURCHAUFFE	1	SX9950760				
136	TUBE VV3V / ECHANGEUR MAX	1	SX5661160				
137	TUBE GAZ	1	SX0610080				
138	JOINT O RING ( x3 )	1	SX5402010				
139	RACCORD ENTREE GAZ	1	SX5210630				
140	VANNE GAZ SIT 845 SIGMA	1	SX5653610				
147	TRAVERSE PLATINE HYDRAULIQUE	1	SX5653160				
151	COUVERCLE BOITIER ELECTRIQUE	1	SX5407650				
152	PANNEAU CDE INITIA MAX 2.24 FF	1	SX5662730				
153	COUVERCLE BRANCHE. ELECTRIQUE	1	SX5407660				
154	CIRCUIT IMPRIME INECO MAX UNIV.	1	SX5657840				
154	CIRCUIT IMPRIME LMU 33	1	SX5669060				
154	CIRCUIT IMPRIME LMU 33	1	SX5678250	B523====>			
166	BARETTE CONNEXION ELECTRIQUE	1	SX8421590				
167	PORTE FUSIBLE ( x3 )	1	SX5405340				
168	FUSIBLE 2A ( x10 )	1	SX8421410				
169	THERMOMANOMETRE	1	SX8922380				
169	MANOMETRE	1	SX5653700				
170	SUPPORT MANOMETRE	1	SX5407750				
174	BOUTON POTENTIOMETRE LUNA	1	SX5408630				
190	JOINT 3/8" ( x10 )	1	SX5404970				
192	JOINT G 3/4" ( x10 )	1	SX5404650				
234	TUBE DISCONNECTEUR	1	SX5657570				
236	ENS. DISCONNECTEUR	1	SX5658650				
240	CLAPET AVEC RACCORD ET O RING	1	SX0608980				
252	SELECTEUR ( x2 )	1	SX8434550				
280	JOINT 14,2x18x1,5 AL-18 ( x3 )	1	SX5207730				
284	PISTON POTENTIOMETRE	1	SX5405990				
314	CABLE ELECTRODE IONISATION ( x2 )	1	SX8418870				
316	RESSORT FIX. MICRO	1	SX8380610				
336	CLIP FIXATION MOTEUR V3V	1	SX8380680				
337	MOTEUR V3V	1	SX5647340				
356	BOUCHON AVANT ( GROUPE )	1	SX5634820				
357	RESSORT SECURITE DEBIT D'EAU	1	SX8380600				
358	PLATEAU SECURITE DEBIT D'EAU	1	SX5634830				
363	JOINT O RING ( x3 )	1	SX5405390				

 <b>IDEAL STANDARD</b> UN CHAUFFAGE D'AVANCE	<b>PIECES DE RECHANGE</b>
	BAXI France - 157, Avenue Charles Floquet - 93158 Le Blanc Mesnil Cedex - Téléphone 33 (0)1 45 91 56 00 - Télécopie 33 (0)1 45 91 59 90

N° 2389

INITIA MAX 2.24 FF

## ENSEMBLE CHAUDIERE

REP	DESIGNATIONS	PIECES COMMUNES		PIECES SPECIFIQUES			
		Qté	Code	Qté	Qté	Qté	Qté
390	PRESSOSTAT POMPE	1	SX0605780				
485	JOINT O RING ( x3 )	1	SX5407510				
486	JOINT ECHANGEUR SANITAIRE ( x4 )	1	SX5404520				
487	ENS. TUBE DEPART VASE EXPANSION	1	SX5658310				
488	ENS. TUBE SORTIE VASE EXPANSION	1	SX5658320				
493	MANETTE ROBINET REMPLISSAGE	1	SX0605660				
496	JOINT O RING 2062 ( x3 )	1	SX0400020				
501	ENS. OBTURATEURE CHAUFFAGE	1	SX0605790				
503	MEMBRANE PRESSOSTAT SANIT ( x3 )	1	SX0400080				
509	PISTON DEBISTAT SANITAIRE	1	SX0605790				
510	ENS. OBTURATEUR SANITAIRE	1	SX0600760				
517	CLIP FIXATION TUBE	1	SX5407840				
518	CHEVILLE PANNEAU COMMANDE	1	SX5112040				
519	LED	1	SX5407780				
520	VOLET	1	SX5112050				
521	RESSORT FIXATION VOLET	1	SX8380730				
525	ALLUMEUR NAC SIT	1	SX8419060				
600	RESSORT FIXATION DISCONNECTEUR	1	SX5112530				
601	JOINT O RING 8,73x1,78 ( x3 )	1	SX5408560				
999	CABLE ALIMENTATION ELECTRIQUE	1	SX8414620				
999	CABLE TIMER	1	SX8418860				
999	CABLE ELECTRIQUE	1	SX8418950				
999	GROUPE CABLE COMMULATEUR / POMPE	1	SX8419130				
999	CABLE EXTRACTEUR / PRESSOST. / LIMIT.	1	SX8419160				
999	CABLE MOTEUR V3V	1	SX8419270				
999	CABLE CONNECTEUR CIRCUIT IMPRIME MAX	1	SX8419400				

## INITIA MAX FF

Repère	Référence	Désignation	Quantité
1	SX5653140	CHASSIS MONTANT VERTICAL (5653140)	1,0000
2	SX5653630	PANNEAU COTE GAUCHE H=763 (5653630)	1,0000
3	SX5653620	PANNEAU COTE DROIT H=763 (5653620)	1,0000
4	SX5113430	PANNEAU AVANT FI	1,0000
5	SX5110290	TRVERSE ARRIERE SUPERIEURE (5110290)	1,0000
6	SX5111710	TRVERSE ARRIERE INFERIEURE (5111710)	1,0000
8	SX5408080	TUBE SILICONE PRESSOSTAT 4,8X8 L=270 (x4) (5408080)	1,0000
9	SX5108700	DIAPHRAGME D:80 (PDM5108700)	1,0000
10	SX5207060	RACCORDMENT VENTOUSE (5207060)	1,0000
11	SX5407890	JOINT VENTOUSE CAOUTCHOUC (5407890)	1,0000
12	SX5108690	OBTURATEUR (5108690)	1,0000
13	SX5407400	JOINT OBTURATEUR DECOUPE (x3)	1,0000
15	SX0600530	COLLIER SORTIE EXTRACTEUR (0600530)	1,0000
17	SX5211090	COUDE (5211090)	1,0000
18	SX5407050	VENTURI (5407050)	1,0000
21	SX5402050	JOINT 6,1x11,5x1,5 (X3)	1,0000
22	SX5653850	EXTRACTEUR 1V MVL RLG108 (5653850)	1,0000
23	SX5629560	PRESSOSTAT HONEYWELL (5629560)	1,0000
24	SX5407930	TUBE SILICONE PRISE LG.150 (5407930)	1,0000
25	SX5653170	HOTTE D'EVACUATION DES FUMEEES (5653170)	1,0000
27	SX5653780	CHAMBRE ETANCHE (5653780)	1,0000
28	SX5213160	PANNEAU ISOLANT LATERAL (5213160)	1,0000
29	SX5213290	PANNEAU ISOLANT ARRIERE 32KW (5213290)	1,0000
30	SX5213340	PANNEAU ISOLANT AVANT (5213340)	1,0000
31	SX5111840	PANNEAU AVANT CHAMBRE COMBUSTION (5111840)	1,0000
32	SX0603280	ECHANGEUR PRINCIPAL (603280)	1,0000
32	SX5632470	ECHANGEUR PRINCIPAL 23KW (PDM5632470)	1,0000
33	SX5403130	O-RING 22X3 EPDM (x3) (5403130)	1,0000
34	SX5112510	CLIP FIXATION ECHANGEUR PRIMAIRE (5112510)	1,0000
35	SX5658420	VASE D'EXPANSION MINI ACCUMULATION (5658420)	1,0000
37	SX5653710	PANNEAU AVANT CHAMBRE ETANCHE (5653710)	1,0000
38	SX5401610	JOINT HUBLLOT (x3) (5401610)	1,0000
39	SX5203930	HUBLLOT (5203930)	1,0000

## INITIA MAX FF

Repère	Référence	Désignation	Quantité
40	SX5103360	COUVERCLE HUBLOT (5103360)	1,0000
41	SX5653310	BRULEUR 12 BECS (5653310)	1,0000
42	SX5604090	ELEMENT BRULEUR (5604090)	1,0000
43	SX0605850	NOURRICE PORTE-INJECTEUR 12T.D.1,28 (605850)	1,0000
43	SX0605990	NOURRICE PORTE-INJECTEUR 12T.D.0,77 (605990)	1,0000
44	SX0608430	KIT INJECTEURS D.1,28 GN (608430)	1,0000
44	SX0608450	KIT INJECTEURS D.0,77 BP (608450)	1,0000
45	SX5407940	JOINT NOURRICE (x3) (5407940)	1,0000
46	SX5657180	RACCORD NOURRICE (5657180)	1,0000
47	SX5407810	JOINT NOURRICE/CAISSON (5407810)	1,0000
49	SX5207070	BOUCHON RACCORDEMENT VENTOUSE (5207070)	1,0000
59	SX8419050	CABLE ELECTRODE D'ALLUMAGE (x2) (8419050)	1,0000
61	SX5407830	PROTECTION ELECTRODE (x3) (5407830)	1,0000
62	SX5409570	PRISE DE PRESSION FF (5409570)	1,0000
62	SX5643090	RACCORD PRISE DE PRESSION (5643090)	1,0000
63	SX8422570	ELECTRODE ALLUMAGE (x4) (8422570)	1,0000
70	SX5653250	TUBE POMPE ECHANGEUR (5653250)	1,0000
72	SX5655200	POMPE GRUNDFOS 15/50 (5655200)	1,0000
73	SX0607290	DEGAZEUR (607290)	1,0000
74	SX5406360	O-RING 14X1,78 (x3)	1,0000
75	SX5404670	JOINT TUBE/CAISSON (x3) (PDM5404670)	1,0000
76	SX5652190	ECHANGEUR SANITAIRE 22 PLAQUES (5652190)	1,0000
80	SX5659040	GROUPE ENTREE SANITAIRE/RETOUR CHAUFFAGE (5659040)	1,0000
82	SX5630170	VENTURI ECS (PDM5630170)	1,0000
83	SX5629240	LIMITEUR DEBIT SANIT.8L/MN	1,0000
84	SX5111180	FILTRE SANITAIRE (x3) (PDM5111180)	1,0000
85	SX5405350	JOINT O-RING FILTRE SANITAIRE (x3) (PDM5405350)	1,0000
87	SX5210710	ELEMENT DE CONNEXION POMPE (5210710)	1,0000
90	SX5630180	ROBINET DE REMPLISSAGE	1,0000
91	SX5652030	ROBINET DE VIDANGE (PDM5652030)	1,0000
92	SX5653690	SOUPAPE DE SECURITE 3 BARS (5653690)	1,0000
96	SX5658290	TUBE PRESSION + (5658290)	1,0000
97	SX5658300	TUBE PRESSION - (5658300)	1,0000

## INITIA MAX FF

Repère	Référence	Désignation	Quantité
98	SX5658280	TUBE BY-PASS (5658280)	1,0000
99	SX5108130	CLIP TUBE DE BY-PASS (PDM5108130)	1,0000
102	SX5659470	VANNE 3 VOIES (5659470)	1,0000
103	SX5652130	PRESSOSTAT SANITAIRE (5652130)	1,0000
108	SX8101420	VIS M4X12 (8101420)	1,0000
109	SX5207810	JOINT (x3) (5207810)	1,0000
112	SX5405960	MEMBRANE SECURITE DEBIT D'EAU (x3) (PDM5405960)	1,0000
114	SX5403820	JOINT O-RING (x3) (5403820)	1,0000
117	SX5646180	BOUCHON AVANT (5646180)	1,0000
118	SX8380520	RESSORT BY-PASS (8380520)	1,0000
120	SX5646190	BOUCHON PRESSOSTAT SANITAIRE	1,0000
122	SX5405370	O-RING "FILTRE SANITAIRE" (x3) (5405370)	1,0000
131	SX8433090	SONDE CTN (PDM8433090)	1,0000
131	SX8434820	SONDE CTN CH et SN MURALE (8434820)	1,0000
132	SX5402830	JOINT SONDE SANITAIRE (X10) (PDM5402830)	1,0000
134	SX5211170	DIAPHRAGME GAZ 4,7mm (5211170)	1,0000
135	SX9950760	SECURITE SURCHAUFFE 105° (9950760)	1,0000
136	SX5661160	TUBE V3V/ECHANGEUR-MAX (5661160)	1,0000
137	SX0610080	TUBE GAZ (610080)	1,0000
138	SX5402010	JOINT O-RING (x3) (PDM5402010)	1,0000
139	SX5210630	RACCORD ENTREE GAZ ((5210630)	1,0000
140	SX5653610	VANNE GAZ SIT (845 SIGMA)	1,0000
147	SX5653160	TRAVERSE PLATINE HYDRAULIQUE (5653160)	1,0000
151	SX5407650	COUVERCLE BOITIER ELECTRIQUE (5407650)	1,0000
152	SX5662730	PANNEAU CDE INITIA MAX 2.24FF	1,0000
153	SX5407660	COUVERCLE BRANCHE.ELECTRIQUE (5407660)	1,0000
154	SX5657840	CIRCUIT IMPRIME INECO MAW UNIVERSAL (5657840)	1,0000
154	SX5669060	CIRCUIT IMPRIME LMU 33 (5669060)	1,0000
154	SX5678250	CIRCUIT IMPRIME LMU33 VANN.SIT (5678250)	1,0000
166	SX8421590	BORNIER DE RACCORDEMENT (PDM8421590)	1,0000
167	SX5405340	PORTE-FUSIBLES (x3) (PDM5405340)	1,0000
168	SX8421410	FUSIBLE 2A (x10) (PDM8421410)	1,0000
169	SX5653700	MANOMETRE (5653700)	1,0000

## INITIA MAX FF

Repère	Référence	Désignation	Quantité
169	SX8922380	THERMOMANOMETRE (8922380)	1,0000
170	SX5407750	SUPPORT MANOMETRE (5407750)	1,0000
174	SX5408630	BOUTON POTENTIOMETRE LUNA (5408630)	1,0000
190	SX5404970	JOINT 3/8" (x10) (PDM5404970)	1,0000
192	SX5404650	JOINT G3/4" 17x24x2 (X10) #	1,0000
234	SX5657570	TUBE DISCONNECTEUR WATTS (5657570)	1,0000
236	SX5658650	DISCONNECTEUR WATTS(jjj005658650)	1,0000
240	SX0608980	CLAPET AVEC RACCORD ET O-RING (608980)	1,0000
252	SX8434550	SELECTEUR (x2) (8434550)	1,0000
280	SX5207730	JOINT 14,2X18X1,5 AL-18 (x3) (5207730)	1,0000
284	SX5405990	PISTON POTENTIOMETRE (5405990)	1,0000
314	SX8418870	CABLE ELECTRODE D'IONISATION (x2) (8418870)	1,0000
316	SX8380610	RESSORT FIX.MICRO (8380610)	1,0000
336	SX8380680	RESSORT FIX MOTEUR V3V	1,0000
337	SX5647340	MOTEUR V3V ELBI	1,0000
356	SX5634820	BOUCHON AVANT (GROUPE) (5634820)	1,0000
357	SX8380600	RESSORT SECURITE DEBIT D'EAU (8380600)	1,0000
358	SX5634830	BOUCHON PRESSOSTAT (5634830)	1,0000
363	SX5405390	JOINT O-RING D=13,60x2,7 (x3) (5405390)	1,0000
390	SX0605780	PRESSOSTAT POMPE (605780)	1,0000
485	SX5407510	JOINT O-RING (x3) (5407510)	1,0000
486	SX5404520	JOINT ECHANGEUR SANITAIRE(x4) (PDM5404520)	1,0000
487	SX5658310	ENS.TUBE DEPART VASE EXPANSION (5658310)	1,0000
488	SX5658320	ENS.TUBE SORTIE VASE EXPANSION (5658320)	1,0000
493	SX0605660	MANETTE ROBINET REMPLISSAGE	1,0000
496	SX0400020	O-RING 2062 (x3) (400020)	1,0000
501	SX0605790	PISTON DEBISTAT SANITAIRE (605790)	1,0000
503	SX0400080	MEMBRANE PRESSOSTAT SANITAIRE (x3) (400080)	1,0000
509	SX0605790	PISTON DEBISTAT SANITAIRE (605790)	1,0000
510	SX0600760	ENS.OBTURATEUR SANITAIRE (600760)	1,0000
517	SX5407840	CLIP FIXATION TUBE (5407840)	1,0000
518	SX5112040	CHEVILLE PANNEAU COMMANDE (5112040)	1,0000
519	SX5407780	LED (5407780)	1,0000
520	SX5112050	VOLET (5112050)	1,0000



## INITIA MAX FF

Repère	Référence	Désignation	Quantité
521	SX8380730	RESSORT FIXATION VOLET (8380730)	1,0000
525	SX8419060	ALLUMEUR NAC-SIT (8419060)	1,0000
600	SX5112530	RESSORT FIXATION DISCONNECTEUR (5112530)	1,0000
601	SX5408560	O-RING 8,73X1,78 (x3) (5408560)	1,0000
-1	SX5407980	JOINT POUR ALLUMEUR NAC SIT (x3) (5407980)	1,0000
-1	SX8414620	CABLE M1 ALIM ELEC (8414620)	1,0000
-1	SX8418860	CONNECTEUR PONT TIMER (8418860)	1,0000
-1	SX8418950	CABLE M1 INTERUPTEUR (8418950)	1,0000
-1	SX8419130	CABLE A4 POMPE-COMMUTATEUR	1,0000
-1	SX8419160	CABLE EXTRACTEUR/PRESSOSTAT/LIMITEUR (8419160)	1,0000
-1	SX8419270	CABLE A8/V3V	1,0000
-1	SX8419400	CABLE A5/CTN-MICRO-MODUL (8419400)	1,0000



PIECES DE RECHANGE

BAXI France - 157, Avenue Charles Floquet - 93158 Le Blanc Mesnil Cedex - Téléphone 33 (0)1 45 91 56 00 - Télécopie 33 (0)1 45 91 59 90

N° 2389

INITIA MAX 2.24 FF

ENSEMBLE CHAUDIERE

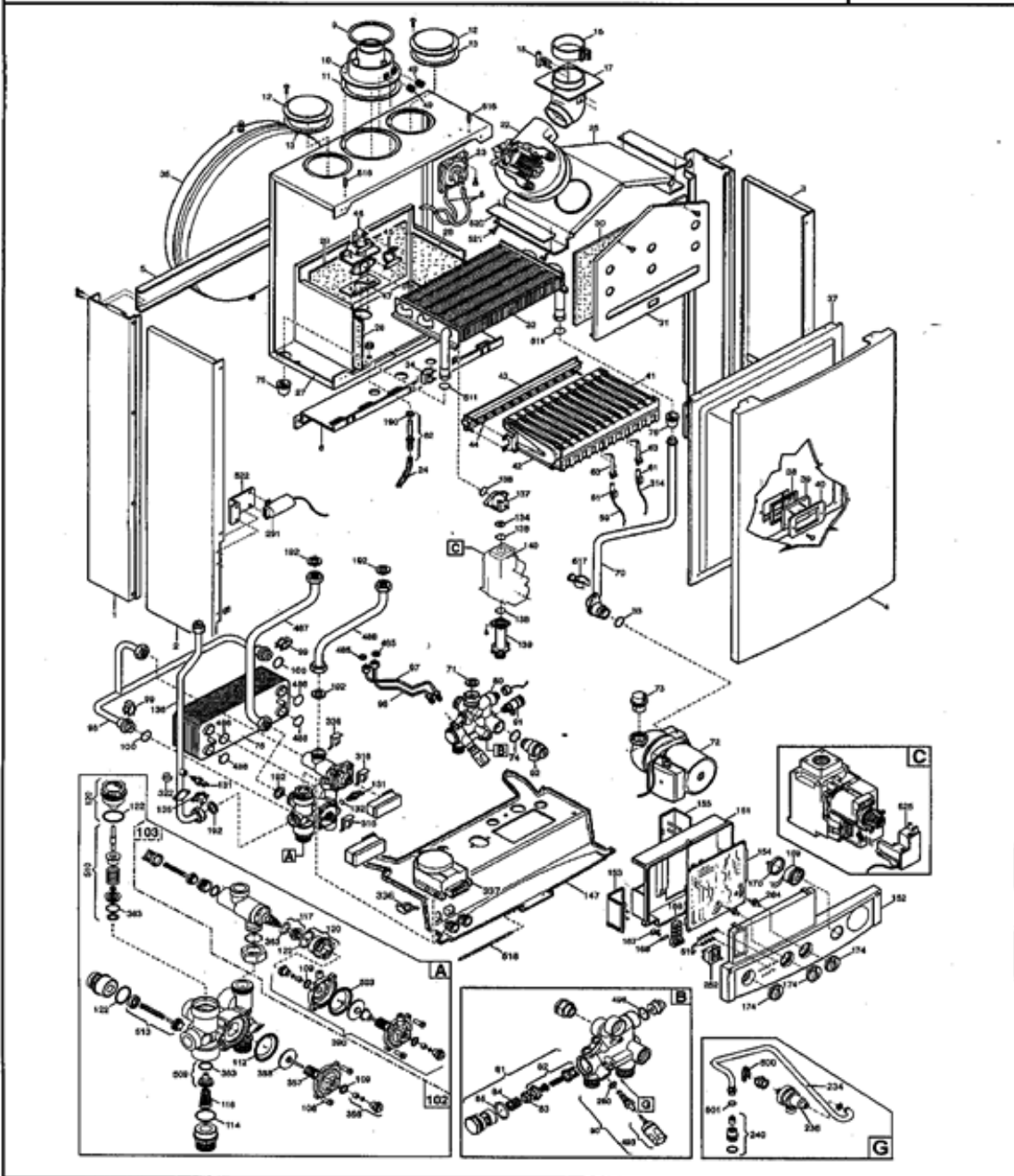

17/11/2005

2389 Initia IS224MaxFF.xls

 <b>PIECES DE RECHANGE</b>		<small>BAXI France - 157, Avenue Charles Floquet - 93158 Le Blanc Mesnil Cedex - Téléphone 33 (0)1 45 91 56 00 - Télécopie 33 (0)1 45 91 59 90</small>					
N° 2167		ZENIS + INITIA					
BARETTE ROBINETTERIE MIXTE 14068011					2002		
REP	DESIGNATIONS	PIECES COMMUNES		PIECES SPECIFIQUES			
		Qté	Code	Qté	Qté	Qté	Qté
191	JOINT G 1/2"	1	SX5404640				
192	JOINT G 3/4"	1	SX5404650				
203	TUBE D. 18	1	SX5657630				
207	COUDE SORTIE SANITAIRE	1	SX5656440				
210	ROBINET GAZ G 3/4	1	SX5650080				
225	ROBINET CHAUFFAGE	1	SX5660650				
292	CONTRE ECROU G 3/4	1	SX9950320				
293	CONTRE ECROU G 1/2	1	SX5204900				
472	TUBE D. 14	1	SX5657640				
490	GROUPE ROBINET ENTREE SANITAIRE G 1/2	1	SX5657830				
619	TRAVERSE PLATINE HYDR. ( ===> 11/2003 )	1	SX5112500				
619	TRAVERSE PLATINE HYDR. ( 11/2003 ===> )	1	SX5113880				
620	TRAVERSE SUPERIEURE	1	SX5112380				
999	GABARIT EN PAPIER	1	SX9219250				
999	SACHET DE VISSERIE DE FIXATION	1	SX5630670				
999	SACHET DE JOINTS	1	SX0614720				

16/04/2003

BaretteMixte IS.xls

## INITIA MAX FF

Repère	Référence	Désignation	Quantité
191	SX5404640	JOINT G 1/2" (x10) (PDM5404640)	1,0000
192	SX5404650	JOINT G3/4" 17x24x2 (X10) #	1,0000
203	SX5657630	TUBE D:18 (5657630)	1,0000
207	SX5656440	COUDE SORTIE SANITAIRE (5656440)	1,0000
210	SX5650080	ROBINET GAZ G 3/4 (5650080)	1,0000
225	SX5660650	ROBINET CHAUFFAGE (5660650)	1,0000
292	SX9950320	CONTRE ECROU G 3/4 (9950320)	1,0000
293	SX5204900	CONTRE ECROU G 1/2 (5204900)	1,0000
472	SX5657640	TUBE D:14 (5657640)	1,0000
490	SX5657830	ROBINET ENTREE SANITAIRE G 1/2 (5657830)	1,0000
619	SX5112500	TRAVERSE PLATINE HYDRAULIQUE (5112500)	1,0000
619	SX5113880	TRAVERSE PLATINE HYDRAULIQUE (5113880)	1,0000
620	SX5112380	TRAVERSE DE FIXATION CHAUDIERE (5112380)	1,0000
-1	SX0614720	SACHET DE JOINTS (0614720)	1,0000
-1	SX5630670	GROUPE VIS DE FIXATION (5630670)	1,0000
-1	SX9219250	GABARIT EN PAPIER (9219250)	1,0000

 <b>IDEAL STANDARD</b> <small>UN CHAUFFAGE D'AVANCE</small>	<b>PIECES DE RECHANGE</b>
<small>BAXI France - 157, Avenue Charles Floquet - 93158 Le Blanc Mesnil Cedex - Téléphone 33 (0)1 45 91 56 00 - Télécopie 33 (0)1 45 91 59 90</small>	

<b>N° 2167</b>	<b>ZENIS + INITIA</b>
----------------	-----------------------

<b>BARETTE ROBINETTERIE MIXTE 14068011</b>	<b>2002</b>
--	-------------

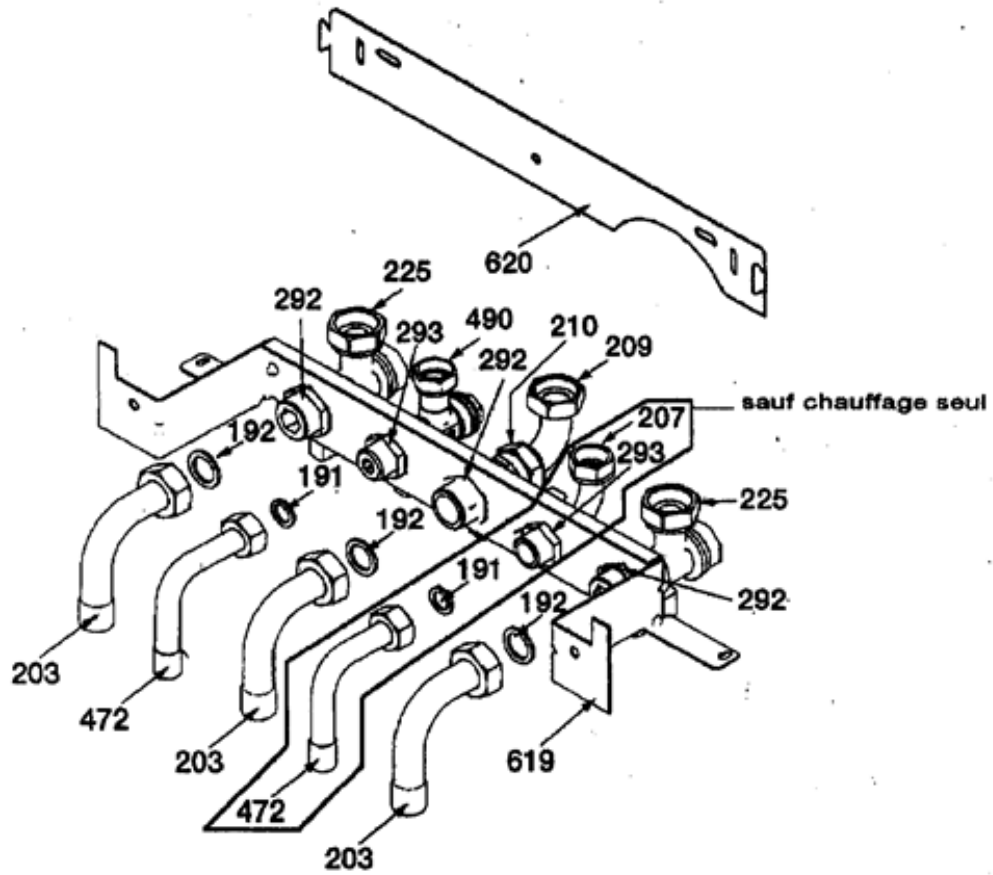

## INITIA MAX FF

Repère	Référence	Désignation	Quantité
220	SX5407990	TERMINAL DE VENTOUSE (5407990)	1,0000
221	SX5103550	ROSACE D'ETANCHEITE (5103550)	1,0000
222	SX1310300	JOINT MASTIC (1310300)	1,0000
223	SX8100757	VIS (8100757)	1,0000
224	SX5627630	TUBE EXTERIEUR (5627630)	1,0000
225	SX5207220	TUBE INTERIEUR (5207220)	1,0000
227	SX5621890	JOINT TUBE D=60 (5621890)	1,0000
228	SX5404960	JOINT ELASTIQUE D=100X75 (5404960)	1,0000
229	SX5630130	JOINT TUBE D=100X75 (5630130)	1,0000
230	SX5627320	COUDE A 90° (5627320)	1,0000
231	SX5630140	JOINT TUBE D=100X40 (5630140)	1,0000
232	SX5404950	JOINT ELASTIQUE D=100X40 (5404950)	1,0000

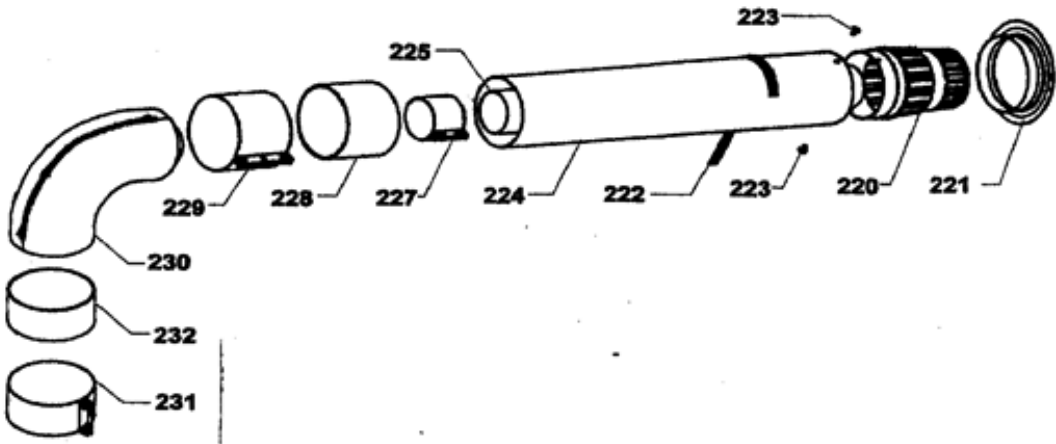
 <b>PIECES DE RECHANGE</b>							
<small>BAXI France - 157, Avenue Charles Floquet - 93158 Le Blanc Mesnil Cedex - Téléphone 33 (0)1 45 91 56 00 - Télécopie 33 (0)1 45 91 59 90</small>							
N° 2194	ZENIS - INITIA						
ENSEMBLE VENTOUSE HORIZONTALE							
							
220	TERMINAL DE VENTOUSSE	1	SX5407990				
221	ROSACE D'ETANCHEITE	1	SX5103550				
222	JOINT MASTIC	1	SX1310300				
223	VIS	1	SX8100757				
224	TUBE EXTERIEUR	1	SX5627630				
225	TUBE INTERIEUR	1	SX5207220				
227	JOINT TUBE D. 60	1	SX5621890				
228	JOINT ELASTIQUE D. 100x75	1	SX5404960				
229	JOINT TUBE D. 100x75	1	SX5630130				
230	COUDE A 90°	1	SX5627320				
231	JOINT TUBE d. 100x40	1	SX5630140				
232	JOINT ELASTIQUE D. 100x40	1	SX5404950				