

SPARE PARTS EXPLODED VIEW SOLARSYSTEM

Model

SOLAR MANAGER IZY/PRO

R8217591-02 - 06/09/2016

1	3024340	SOLAR MANAGER IZY	06-2015	-
2	3024252	SOLAR MANAGER PRO - AR	06-2014	-
2	3024253	SOLAR MANAGER PRO - CHX	06-2014	-
3	3024273	PROBE PT1K PRO - COLLECTOR	06-2014	-
4	3024274	PROBE PT1K PRO - STORAGE	06-2014	-
5	3024275	PROBE PT1K PRO - PIPE	06-2014	-
Col	Reference	Model type	Begin	End

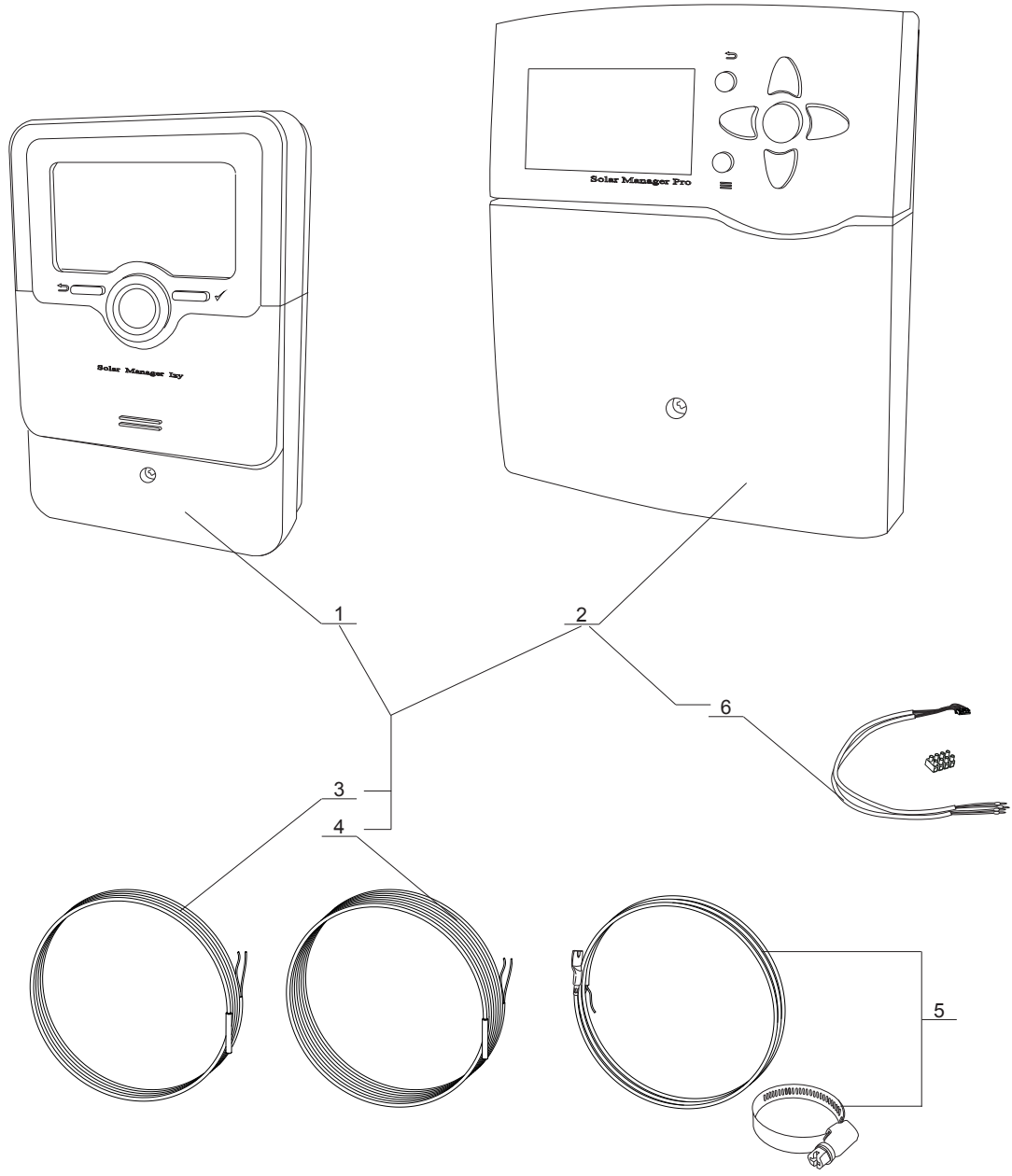

☉	Description	Manf. Pt. N	Type	30242310 3024232 - 3024233 3024273 3024274 3024275																		31	
				1	2	3	4	5	6	7	8	9	10	11	12	13	14	15	16	17	18	From	to

0001	SOLAR MANAGER IZY	65116117		•																		
0002	SOLAR MANAGER PRO	65116118			•																	
0003	COLLECTOR SOLAR SONDE	65116119		•	•	•																
0004	SOLAR TANK SENSOR	65116120		•	•		•															
0005	SOLAR SONDE WITH SCREWED CLAMP	65116121						•														
0006	PWM/0-10V ADAPTER CABLE WITH TERM. 4-PIN	65116213			•																	

SOLAR MANAGER IZY/PRO

Solar system

LIST OF THE ABBREVIATIONS

HW	: Hot water.
CW	: Cold water.
C	: Ceramic resistance (normal heating).
Ca	: Ceramic resistance (accelerated heating)
TP	: Immersion heater.
1F	: With fittings.
2F	: Without fittings.
3F	: With fittings and another outlet connection.
AMI	: With mixing valve.
SMI	: Without mixing valve.
PUISS	: Power of th appliance.
PN	: Appliance with normal pression.
LP	: Appliance with low pression.
PV	: Appliance with variable power.
PF	: Appliance with fixed power.

The indications mentioned on the prices, commercial or technical literature and the scheme are written for your guidance and are available at a given time. The CONSTRUCTOR retains the power to modify the presentation, the form, the size, or the conception or the material of the products.
