

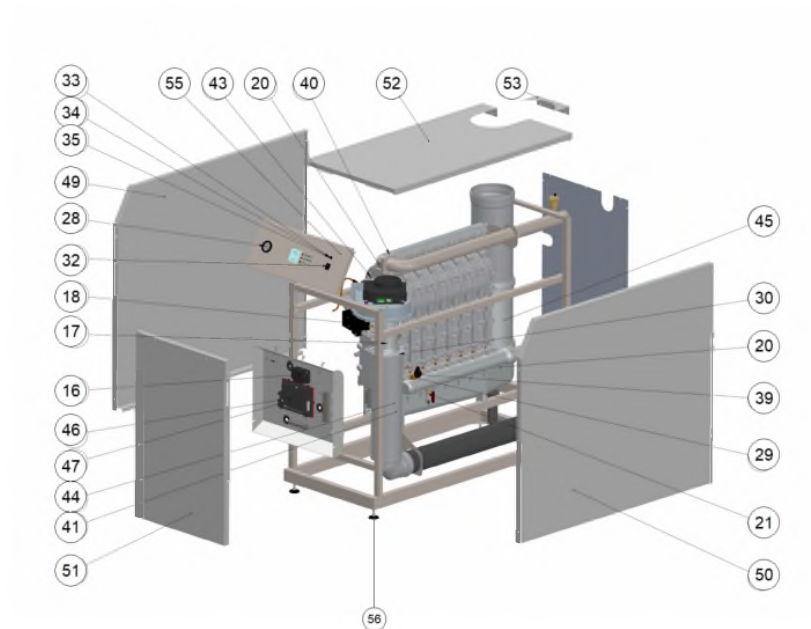

Compact Condens (CC)













CC 170-300 (1)

	Code	Code GA	Quant.	Photo	Description
16	A1003149	787118	1		Transfo allumage ZT931 CC
17	A1003226	787151	1		Venturi VMU185A1009 CC 170
17	A1003227	787152	1		Venturi VMU300A1004 CC 210
17	A1003228	787153	1		Venturi VMU335A1000 CC 250/300
18	A1003163	787132	1		Vanne gas VR420VE5001-0000 CC170
18	A1003165	787134	1		Vanne gas VR425VE5022-0000 CC210-250-300
20	A1003206	787149	1		Sonde NTC 12K 1/4 L 50
21	55426001	785274	1		Robinet de vidange 1/2
28	A1003147	787116	1		Manomètre 0-6bar
29	557A5005	786717	1		Raccord manomètre 1/4 +clap.AR
30	557A0045	786579	1		O-ring 110x3.5 HM201
32	A1003246	787169	1		Interrupt.noir 1/0 22x30 CC
33	A1003247	787170	1		Fusible 5A lent CC
39	A1003166	787135	1		Capteur pression d'eau CC
40	A1003152	787121	1		O-ring 66x4 EPDM
41	A1003145	787114	1		Silencieux entrée d'air Ø110
43	A1003155	787124	1		Joint électrode allum. CC170-300
44	A1003146	787115	1		Silencieux entrée d'air Ø110 CC 300
45	A1003160	787129	1		Silencieux fumée Ø200 L 355 CC
46	A1003193	787142	1		Automate brûleur CC 170



CC 170-300 (1)

	Code	Code GA	Quant.	Photo	Description
46	A1003194	787143	1		Automate brûleur CC 210
46	A1003195	787144	1		Automate brûleur CC 250
46	A1003196	787145	1		Automate brûleur CC 300
47	A1003248	787171	1		Fusible 3.15A lent CC
49	A1003239	787162	1		Lat. gauche CC
50	A1003240	787163	1		Lat. droit CC
51	A1003241	787164	1		Avant CC
52	A1003242	787165	1		Couvercle CC
53	A1003243	787166	1		Couvercle Arrière CC
55	A1003245	787168	1		Avant display CC
56	A1004549	787339	1		Pied réglable M10 CC
99	A1003143	787112	1		Câblage Compact Condens
99	A1003198	787147	1		Câble interface PC CC
99	A1004548	787338	1		Support tube 31-35mm CC

CC 170-300 (2)

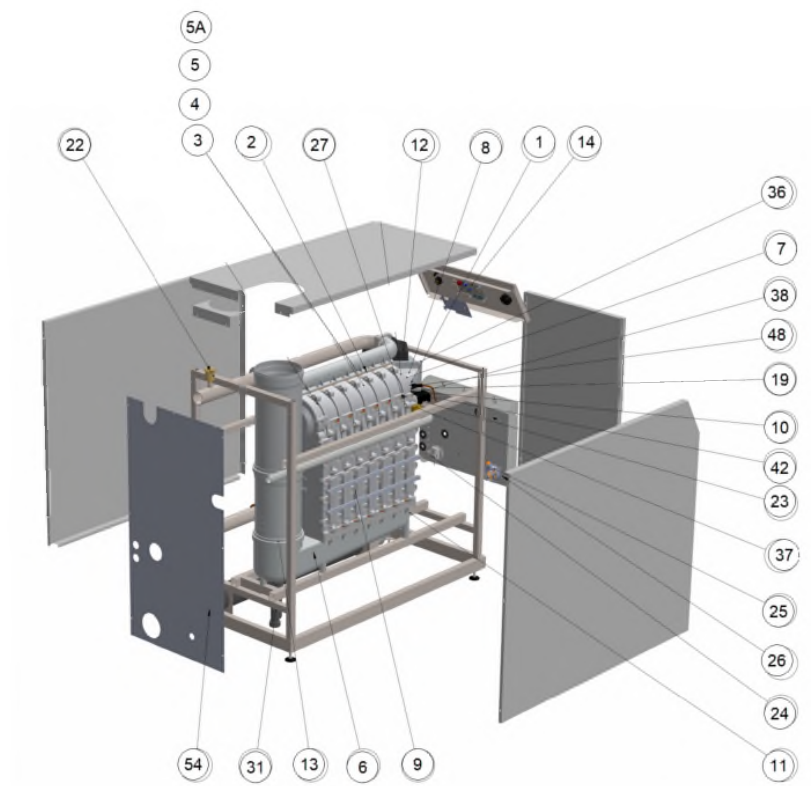

CC 170-300 (2)

☒	Code	Code GA	Quant.	Photo	Description
1	A1003114	787096	1		électrode d'allumage Compact Condens OBS
2	A1003151	787120	1		O-ring 36,09x3,53 EPDM
3	A1003229	787154	1		Assembl Echangeur compact condens 170
4	A1003230	787155	1		Echangeur assembl compact condens 210
5	A1003231	787156	1		Echangeur assembl compact condens 250
5A	A1003463	787204	1		Echangeur assembl compact condens 300
6	A1003232	787157	1		Bac condens CC 170
6	A1003233	787158	1		Bac condens CC 210
6	A1003234	787159	1		Bac condens CC 250
6	A1003235	787160	1		Bac condens CC 300
7	A1003108	787091	1		brûleur Compact Condens 170 - 5L
7	A1003109	787092	1		brûleur Compact Condens 210 - 6L
7	A1003110	787093	1		brûleur Compact Condens 250 - 7L
7	A1003111	787094	1		brûleur Compact Condens 300 - 8L
8	A1003238	787161	1		Porte brûleur Compact Condens
9	A1003157	787126	1		Joint echangeur CC170-300
10	A1003154	787123	1		OBS Joint coiffe CC170-300 ->A1005373
11	A1003156	787125	1		Joint bac condens CC170-300
12	A1003265	787176	1		Ventil. Compact Condens
13	A1003144	787113	1		Joint à lèvres fumée Ø200



## CC 170-300 (2)

☰	Code	Code GA	Quant.	Photo	Description
14	A1003113	787095	1		Display board DSP49G2193 CC
16	A1003149	787118	1		Transfo allumage ZT931 CC
19	A1003150	787119	1		Câble d'allumage Compact Condens
22	A1003224	787150	1		Purgeur air auto 3/8
23	537DC000	786426	1		Pressostat gaz Prest.-HMTc
24	A1003107	787090	1		Pressostat d'air CC
25	A1003164	787133	1		Pressost siphon CC
26	A1003192	787141	1		Steun APS-SPS type snapping
27	A1003148	787117	1		T-stat+reset 105°C CC
31	91844047	785590	1		Siphon HR
36	A1003159	787128	1		Joint ventilateur CC
37	A1003153	787122	1		Joint collecteur 44x32x2
38	A1003142	787111	1		électrode ioni.Compact Condens OBS
42	A1003158	787127	1		Joint électrode d'ionisation CC170-300
48	A1003264	787175	1		suppresseur cable d'allumage CC
54	A1003244	787167	1		Arrière CC
99	A1003143	787112	1		Câblage Compact Condens
99	A1003198	787147	1		Câble interface PC CC
99	A1003919	787283	1		Set cablage cascade - modbus CC



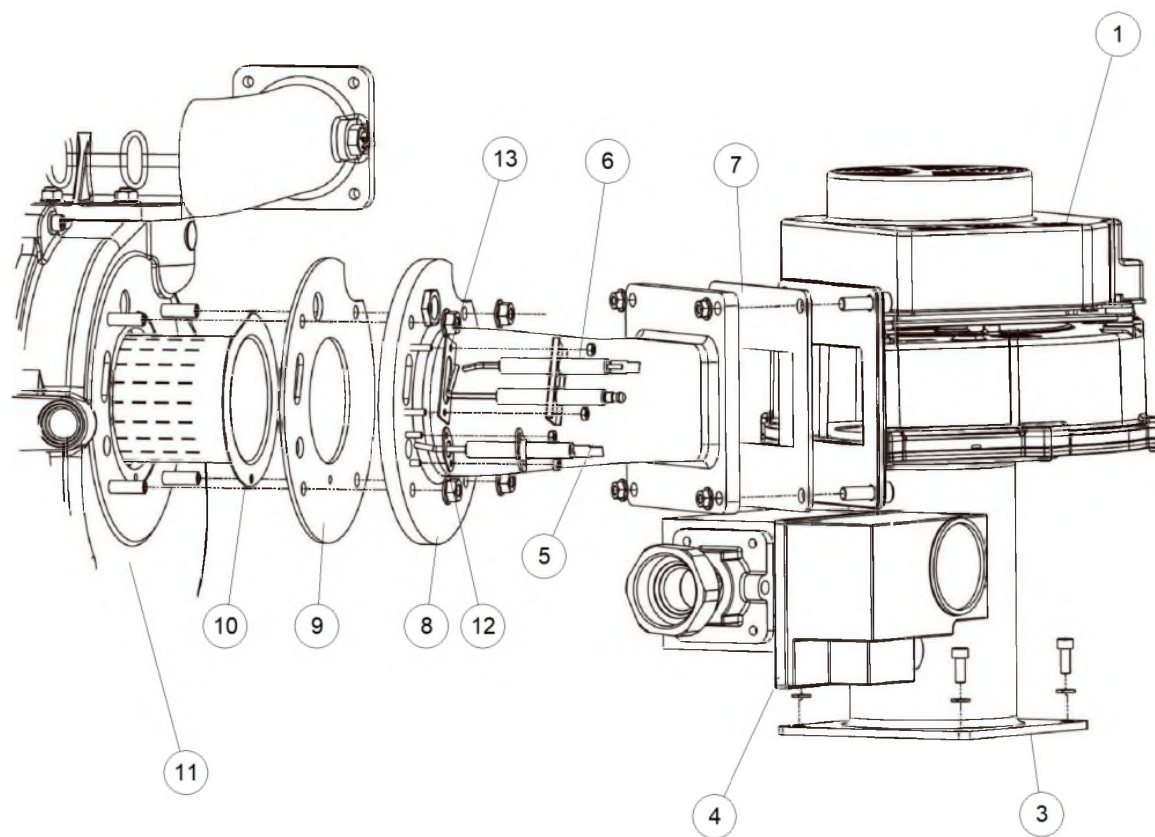









Burner CC 170-300







## Burner CC 170-300

Code	Code GA	Quant.	Photo	Description	De --- A ---	Remarque
1	A1003265	787176	1	 Ventil. Compact Condens		
3	A1003226	787151	1	 Venturi VMU185A1009 CC 170		
3	A1003227	787152	1	 Venturi VMU300A1004 CC 210		
3	A1003228	787153	1	 Venturi VMU335A1000 CC 250/300		
4	A1003163	787132	1	 Vanne gas VR420VE5001-0000 CC170		
4	A1003165	787134	1	 Vanne gas VR425VE5022-0000 CC210-250-300		
5	A1005374	788165	1	électrode ioni.CC170-300	01-05-18-	Prev:A1003142
6	A1005372	787444	1	électrode d'allumage CC170-300	01-05-18-	Prev:A1003114
7	A1003159	787128	1	 Joint ventilateur CC		
8	A1003238	787161	1	 Porte brûleur Compact Condens		
9	A1005373	787445	1	Set joint+ecrous coiffe CC170-300	01-05-18-	Prev:A1003154
10	A1003108	787091	1	 brûleur Compact Condens 170 - 5L		
10	A1003109	787092	1	 brûleur Compact Condens 210 - 6L		
10	A1003110	787093	1	 brûleur Compact Condens 250 - 7L		
10	A1003111	787094	1	 brûleur Compact Condens 300 - 8L		
11	A1003229	787154	1	Assembl Echangeur compact condens 170		
11	A1003230	787155	1	Echangeur assembl compact condens 210		
11	A1003231	787156	1	Echangeur assembl compact condens 250		
11	A1003463	787204	1	Echangeur assembl compact condens 300		
12	A1003158	787127	1	 Joint électrode d'ionisation CC170-300		



Burner CC 170-300

🗨	Code	Code GA	Quant.	Photo	Description	De --- A ---	Remarque
13	A1003155	787124	1		Joint électrode allum. CC170-300		

## CC 340-600 panels

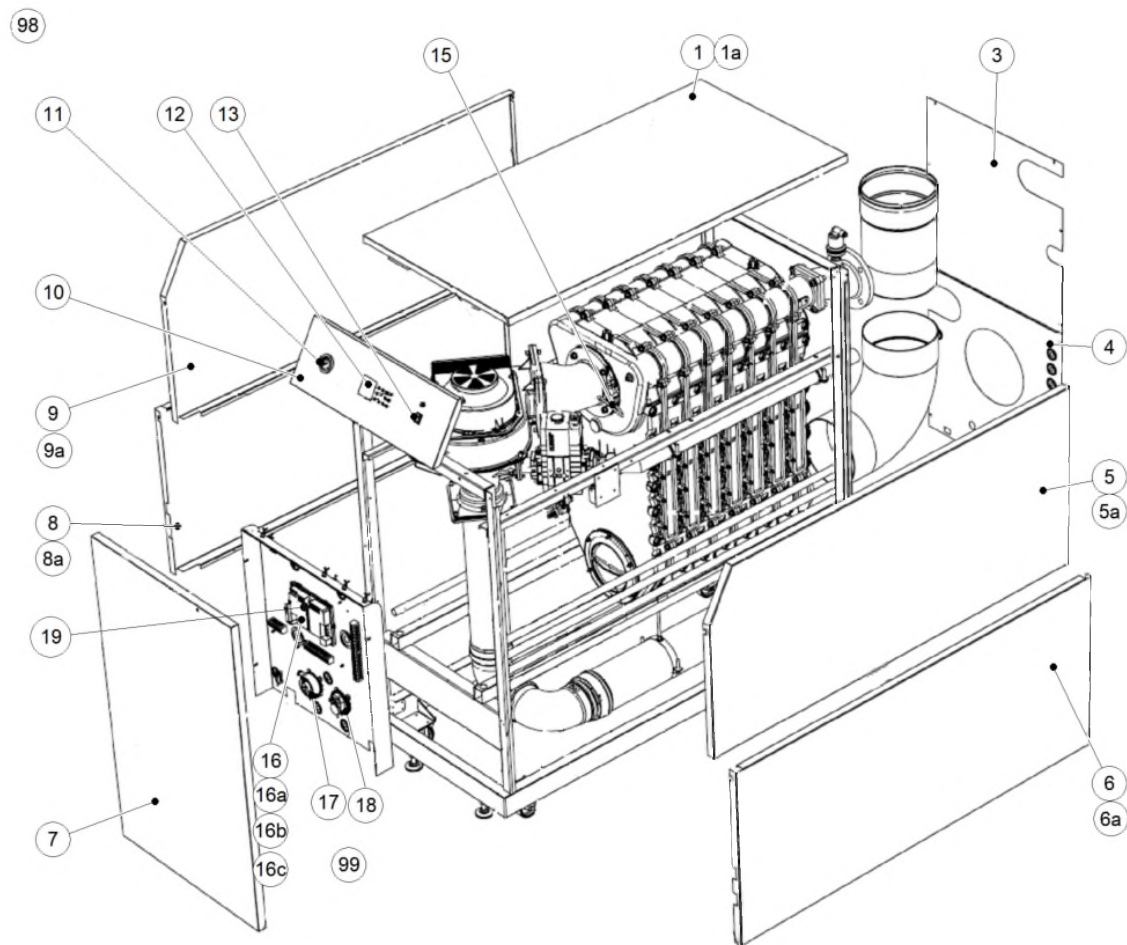







## CC 340-600 panels

☒	Code	Code GA	Quant.	Photo	Description
1	A1005231		1		Couvercle CC 340-425
1a	A1005232		1		Couvercle CC 510-600
3	A1005233		1		Arrière sup. CC 340-600
4	A1005234		1		Arrière inf. CC 340-600
5	A1005235		1		Lat.droit sup. CC 340-425
5a	A1005236		1		Lat.droit sup. CC 510-600
6	A1005237		1		Lat.droit inf. CC 340-425
6a	A1005238		1		Lat.droit inf. CC 510-600
7	A1005239		1		Avant CC 340-600
8	A1005240		1		Lat.gauche inf. CC 340-425
8a	A1005241		1		Lat.gauche inf. CC 510-600
9	A1005242		1		Lat.gauche sup. CC 340-425
9a	A1005243		1		Lat.gauche sup. CC 510-600
10	A1005244		1		Tableau (tôle) CC 340-600
11	A1003147	787116	1		Manomètre 0-6bar
12	A1003113	787095	1		Display board DSP49G2193 CC
13	A1003246	787169	1		Interrupt.noir 1/0 22x30 CC
15	A1005245		1		Câble allumage CC 340-600
16	A1005246	787434	1		Automate brûleur CC 340
16a	A1005248	787435	1		Automate brûleur CC 425



CC 340-600 panels

☒	Code	Code GA	Quant.	Photo	Description
16b	A1005249	787436	1		Automate brûleur CC 510
16c	A1005250	787437	1		Automate brûleur CC 600
17a	A1003192	787141	1		Steun APS-SPS type snapping
17	A1005251		1		Pressostat sécurité CC 340-600
18	A1003107	787090	1		Pressostat d'air CC
19	A1003149	787118	1		Transfo allumage ZT931 CC
98	A1003198	787147	1		Câble interface PC CC
99	A1005252		1		Câblage CC 340-600



CC 340-600 internal

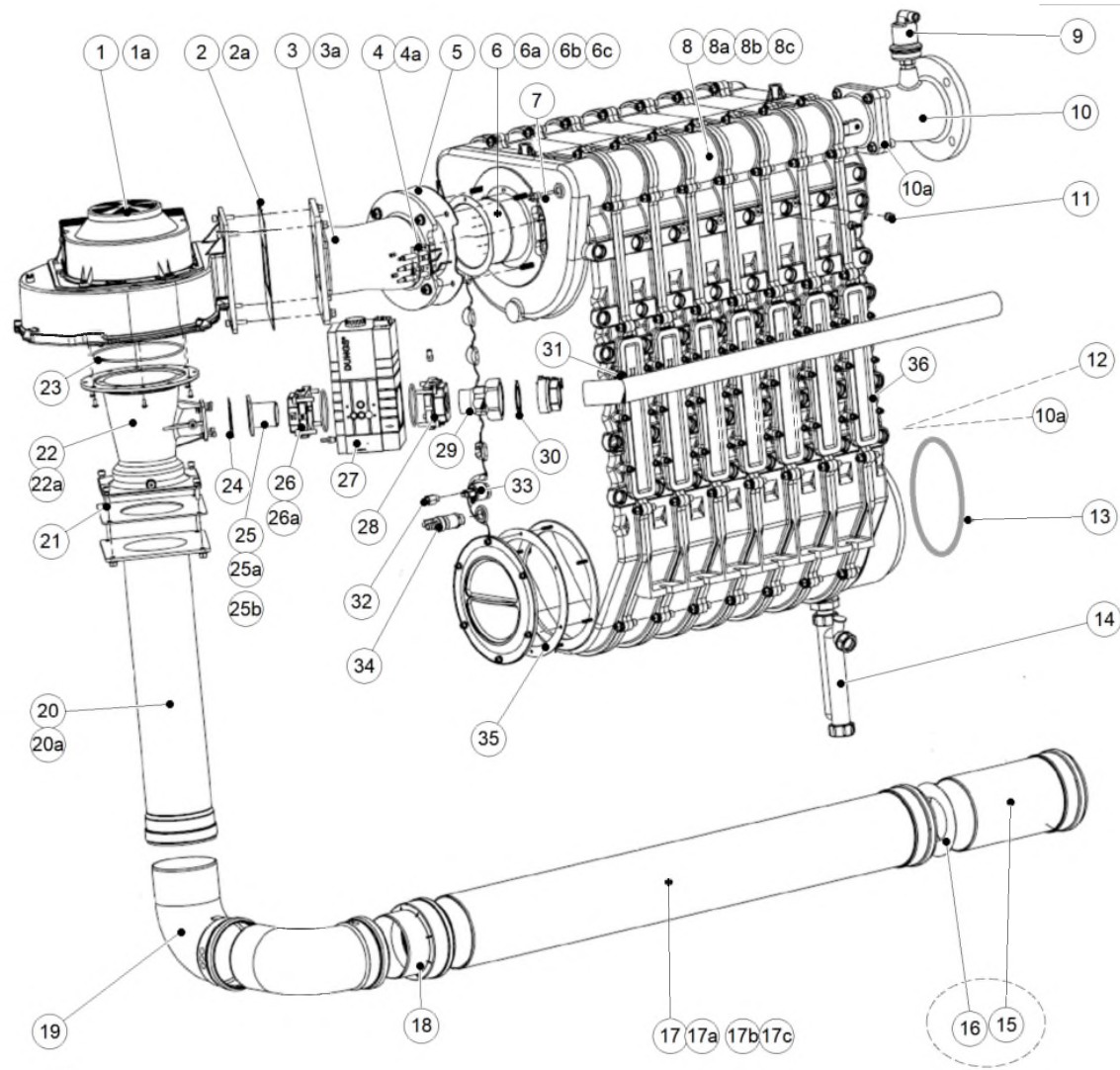



CC 340-600 internal

	Code	Code GA	Quant.	Photo	Description	Remarque
	A1005302		1		Silencieux fumée d:250 CC	
1	A1005253	788163	1		Ventil. G3G200-GN20-01 CC 340-425	CC 340 & 425
1a	A1005254	788164	1		Ventil. G3G250-GN17-01 CC 510-600	CC 510 & 600
2	A1005255		1		Joint ventil. G3G200 CC 340-425	CC 340 & 425
2a	A1005256		1		Joint ventil. G3G250 CC 510-600	CC 510 & 600
3	A1005257		1		Capot brûleur G3G200 CC 340-425	CC 340 & 425
3a	A1005258		1		Capot brûleur G3G250 CC 510-600	CC 510 & 600
4	A1005259	787438	1		électrode ignition-Honis. CC340-600	
4a	A1005260	787439	1		Joint électrode CC340-600	
5	A1005261		1		Joint capot brûleur CC 340-600	
6	A1005262		1		Rampe CC 340	
6a	A1005263		1		Rampe CC 425	
6b	A1005264		1		Rampe CC 510	
6c	A1005265		1		Rampe CC 600	
7	A1003206	787149	1		Sonde NTC 12K 1/4 L 50	
8	A1005266		1		Echangeur CC 340 (ens.complet)	
8a	A1005267		1		Echangeur CC 425 (ens.complet)	
8b	A1005268		1		Echangeur CC 510 (ens.complet)	
8c	A1005269		1		Echangeur CC 600 (ens.complet)	
9	A1005270		1		Purgeur auto Spirotop for CC	







## CC 340-600 internal

	Code	Code GA	Quant.	Photo	Description	Remarque
10	A1005271		1		Bride raccord départ CC	
10a	A1005273		1		O-ring 97,79x5,33 (CC)	
11	A1003148	787117	1		T-stat+reset 105°C CC	
12	A1005272		1		Bride raccord retour CC	
13	A1005274		1		Joint à lèvres d:250 sortie fumée CC	
14	A1005275		1		Siphon WH150 CC	
15	A1005276		1		Tube air d:150 l:280 CC340 CC510	CC 340 & 510
16	A1005277		1		Opércule air CC 340-CC 510	
17	A1005278		1		Tube amenée air L:590 CC 340	
17a	A1005279		1		Tube amenée air L:915 CC 425	
17b	A1005280		1		Tube amenée air L:855 CC 510	
17c	A1005281		1		Tube amenée air L:1180 CC 600	
18	A1005282		1		Reduction 130->150 PP amenée air CC	
19	A1005283		1		Coude 90° d:130 PP amenée air CC	
20	A1005284		1		Silencieux amenée d'air CC 340	CC 340
20a	A1005285		1		Silencieux amenée d'air CC 425-510-600	CC 425-510-600
21	A1005286		1		Joint silencieux-venturi CC	
22	A1005287		1		Venturi VMU500A1009	CC 340 & 425
22a	A1005288		1		Venturi VMU680A1009	CC 510 & 600
23	A1005289		1		O-ring 180x3,5 (Venturi CC)	





## CC 340-600 internal

Code	Code GA	Quant.	Photo	Description	Remarque
24	A1005290	1		Joint raccord Venturi-vanne gaz CC	
25	A1005291	1		Raccord venturi->vanne gaz 1" CC 340-425	CC 340 & 425
25a	A1005292	1		Raccord venturi->vanne gaz 1" CC 510	CC 510
25b	A1005293	1		Raccord venturi->vanne gaz 1"1/2 CC 600	CC 600
26	A1005294	1		Shutter complet NPT 1" CC 340-425	CC 340 & 425
26a	A1005295	1		Shutter complet NPT 1"1/2 CC 510-600	CC 510 & 600
27	A1005296	787440	1	Vanne gaz MBC 700 SE S02 (CC 340-600)	
28	A1005297	1		Bride vanne gaz MBC CC 340-600	
29	A1005298	1		Raccord union 1"1/2 fig.331 CC	
30	A1005299	1		Joint 62x48x2 pour gaz	
31	537DC000	786426	1	 Pressostat gaz Prest.-HMTc	
32	557A5005	786717	1	 Raccord manomètre 1/4 +clap.AR	
33	A1003166	787135	1	 Capteur pression d'eau CC	
34	55426001	785274	1	 Robinet de vidange 1/2	
35	A1005300	1		Joint trappe inspect. CB	
36	A1005301	1		Joint trappe inspect. WW	