

E-Tech W 22 Tri

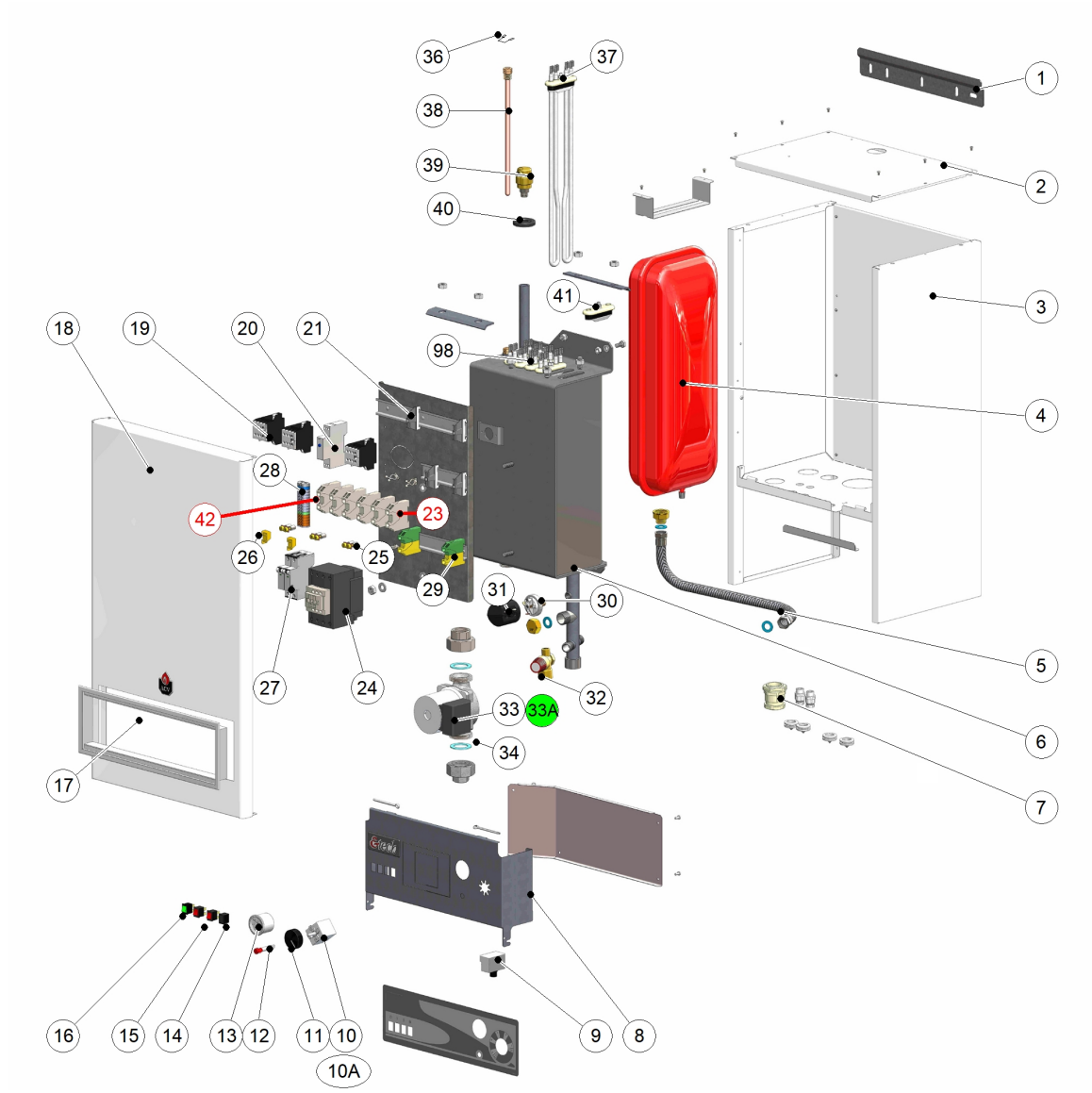



E-Tech W 22 Tri

Code	Code GA	Quant.	Photo	Description	De --- A ---	Remarque
1	21480084	784697	1	Fixation murale E-Tech (V04)	01-01-11-	
2	21475421	784627	1	supérieur E-Tech (V04)	01-01-11-	
3	053066	053066	1	Boitier externe peint E Tech W V14	11-02-22-	Prev :21476421
4	557A7006	786723	1	Vase expans.10L CH	01-01-11-	
5	557A2012	786691	1	Flexible 1/2 L500 E-Tech	01-01-11-	
6	30539484	784782	1	Corps peint E-Tech W22	01-01-11-	
7	54428113	785141	1	Presse-étoupe PG29	01-01-11-	
8	24614230		1	Tableau cpl E-Tech W 22 Tri V14	01-09-14-	Prev: 24614202
9	54764009	785208	1	T-stat+reset 103°C cap1500bulb6 TS-RM-DT	01-01-11-	
10A	54764033	785221	1	T-stat 15/22-78/85 cap3000 bulb6 DT	-15-03-13	SN <10000
11	54764021	785212	1	Bouton rotatif thermostat-trait blanc	01-01-11-	
12	54766001	785226	1	Voyant rouge D10 230V	01-01-11-	
13	54763012	785198	1	Thermomanomètre D40 cap1500	01-01-11-	
14	497B1031	785874	1	Obturateur noir 13x19	01-01-11-	
15	54766017	785235	2	Interrupteur 2P jaune	01-01-11-	
16	54766016	785234	1	Interrupteur 2P vert	01-01-11-	
17	497B1034	785875	1	Cache ABS tableau E-Tech V04	01-01-11-	
18	21473421	784597	1	Avant E-Tech (V04)	01-01-11-	
19	A1003755	787265	3	Relais 4P AC-1 E Tech W (V16)	01-12-17-	Prev: 54452082
20	A1003527	787217	1	Relais temporisé E-Tech	01-12-16-	Prev: 54769007





E-Tech W 22 Tri

Code	Code GA	Quant.	Photo	Description	De --- A ---	Remarque
21	54452092	785180	4	Butée de blocage rail DIN	01-01-11-	
23	54428179	785148	0	Borne 16 mm² WKN 16/U	01-01-11-01-12-17	Not used after 1/12/2017
24	A1002832		1	Contacteur 3NO 32A LC1D32P7	01-09-14-	Prev : 54762072
25	54428278	785160	3	Pontage IVBWKN 16-2 WZ728422270	01-01-11-	
26	5476Z019		2	Cloison de séparation bornes E-Tech P	01-01-11-	
27	A1003753		1	Disjoncteur 2P 6A (E-Tech W V16)	01-12-17-	Prev: 54766015
28	54767028	785246	1	Bornier 15 pôles E-Tech w	01-01-11-	
29	54428155	785147	2	Borne WKN10 SL/U jaune/vert	01-01-11-	
30	A1003191	787140	1	kit pressostat 220V (prev: 557a1056)	01-08-16-	
31	5476V006	786540	1	Capot IP44 pressostat manque +vis	01-01-11-	
32	55426017	785275	1	Soupape secur.3bar 1/2 50kW	01-01-11-	
33	557A4009	786700	1	Circul.RS25/6-3 L130-3 G6/4	01-01-11-31-07-15	non ERP
33A	A1007650	780435	1	ASSEMBLAGE UPM3 AUTO 25-70 L130 & CONNEC	29-10-19-	ERP - prev : 557A4033 -prev A1006374
34	55412047	785269	2	Joint 44-30x2 néoprène	01-01-11-	
36	47438008	784872	1	Epingle fixation sonde	01-01-11-	
37	54428182	785149	5	Resist.chauff. 2 x 2,4kW	01-01-11-	
38	63438003	785297	1	Doigt de gant laiton 3/8x250	01-01-11-	
39	55445007	785283	1	Purgeur air auto.3/8 avec clapet AR	01-01-11-	
40	557A0060	786585	1	Joint soufflet d:21 Dp:40	01-01-11-	
41	497b1019	785872	1	Bouchon type resist.chauff. E-tech	01-01-11-	



E-Tech W 22 Tri

		Code	Code GA	Quant.	Photo	Description	De --- A ---	Remarque
42		54428091	785139	0		Cache borne APN 16 mm2	01-07-11-01-12-17	Not used after 1/12/2017
98		257F1127	785782	6		Pontage 4mm ² bleu L:100mm	01-07-10-	
99		257F1132	785785	0		Kit câblage pour ECS E-tech-W	01-07-11-	option, with 10800085
90		60772039	788129	1		boîte carton E-Tech 920x492x355		