

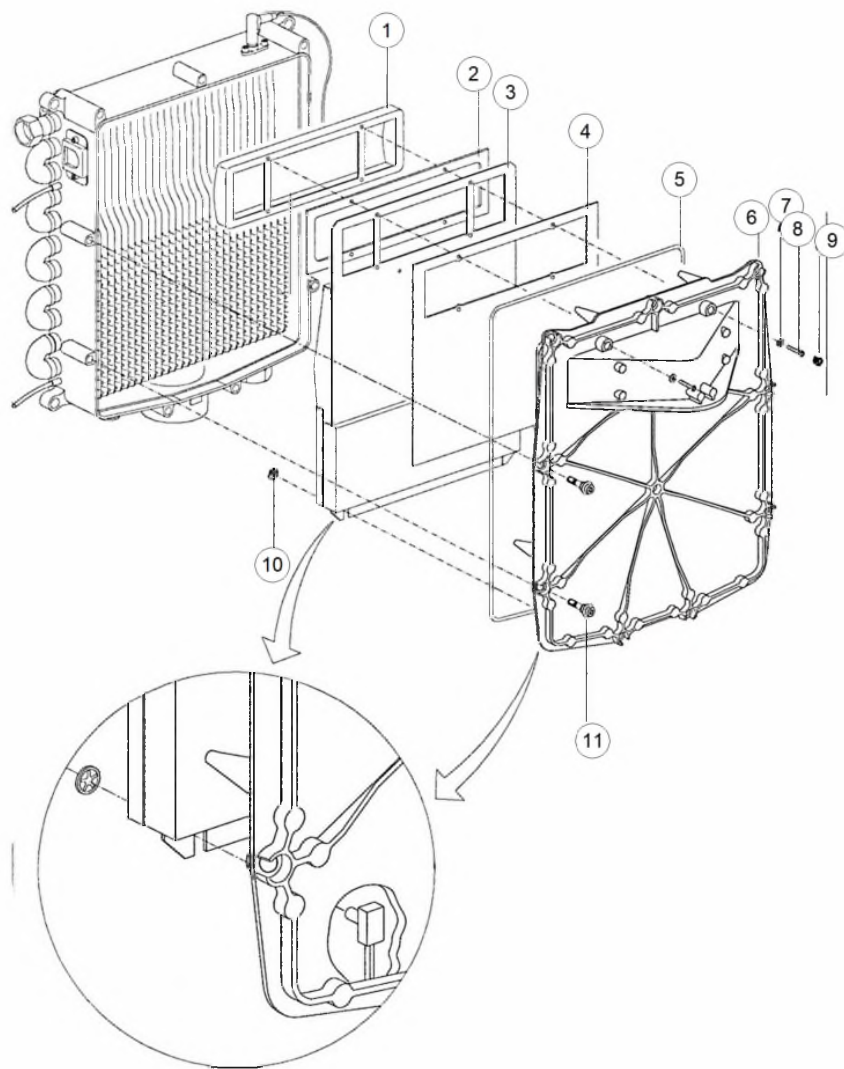



Burner > HRE-HiP





Burner > HRE- HiP

| Code | Code GA | Quant. | Photo | Description | De --- A --- | Remarque |
|------|----------|--------|-------|--|--------------|----------------|
| 1 | 91800327 | 785555 | 1 |  Rampe brûleur HRE | | |
| 2 | 91877847 | 785665 | 1 | Joint rampe brûleur HR(E) | | |
| 3 | 91073607 | 785424 | 1 | Isolation brûleur HRE 36/30 Solo30 | | |
| 4 | 91876377 | 785654 | 1 | Garniture avant boîtier isolant 36/30 | | |
| 5 | A1007569 | 780398 | 1 | Joint Viton HR28-32-36/30-HRE36/30-HRE eco 40 Solo | 11-02-20- | Prev :91876597 |
| 6 | 91081227 | 785442 | 1 | Plaque av.brûleurV13 HRE35-36/30-36/39 | | |
| 7 | A1005482 | 787452 | 4 | O-ring 6x1.5 silicone | | prev: 91875917 |
| 8 | 91362157 | 785542 | 4 | Vis 4,2x25 T20 Inox | | |
| 9 | 91873577 | 785639 | 1 |  Ressort de mise à la terre brûleur HRE | | |
| 10 | 91390087 | 785544 | 2 |  Starlock 4mm inox | | |
| 11 | A1005481 | 787451 | 9 |  Vis épaulée face avant brûleur HRE M8*40 | | prev: 91305157 |





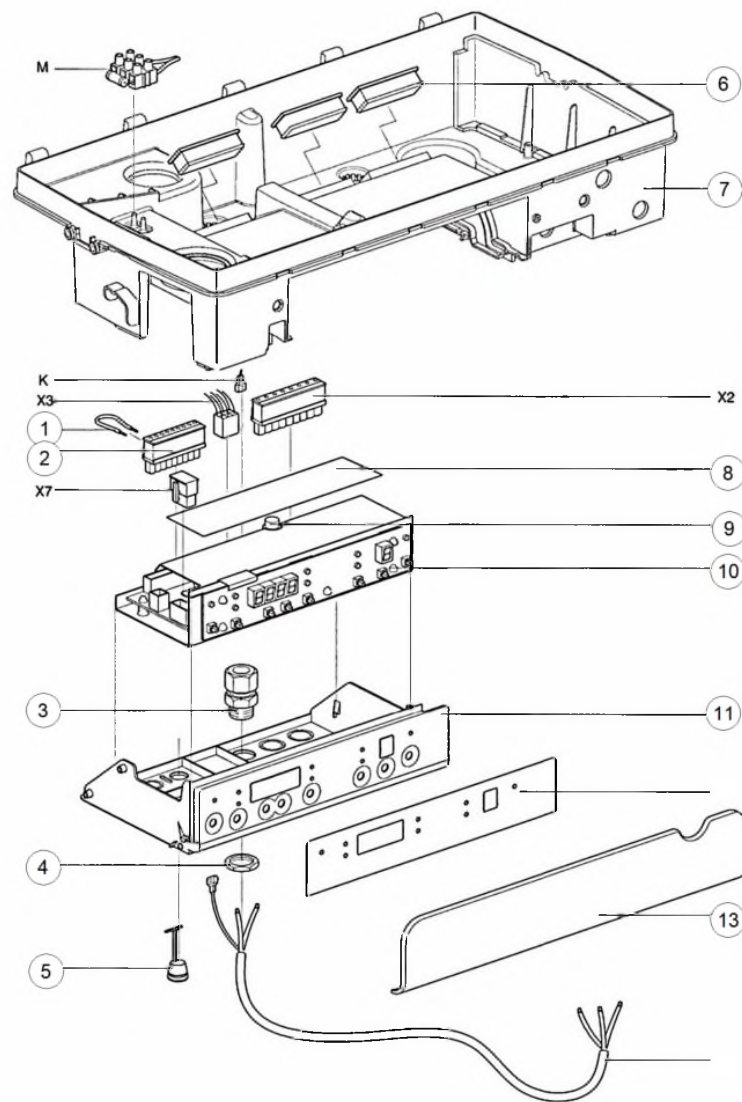

Controller > HRE-HIP





Controller > HRE-HiP

| |  | Code | Code GA | Quant. | Photo | Description | Remarque |
|----|--|----------|---------|--------|---|-------------------------------------|----------------|
| 1 | | 91230687 | | 1 | | Pontage jaune | |
| 2 | | 91260427 | 785529 | 1 |  | Connecteur 9 pôles 5mm 24V | |
| 3 | | 91260467 | 785531 | 1 | | Presse-étoupe M16x1,5 | prev: 91260047 |
| 5 | | 91490097 | 785547 | 1 | | Bouchon | |
| 6 | | 91878567 | | 1 | | Passe-fil Kompakt | |
| 7 | | 91845327 | 785608 | 1 | | Caisson inférieur HRE | |
| 8 | | 91886807 | | 1 | | Autocollant racc.élec HRE | |
| 9 | | 91240277 | 785526 | 1 |  | Fusible 5x20 2A-T | |
| 10 | | 91074567 | | 1 | | Automate brûleur HRE HiP | |
| 11 | | 91845367 | 785609 | 1 | | Support automate et display | |
| 13 | | A1002187 | 786865 | 1 |  | Clapet display HRE blanc + logo ACV | |





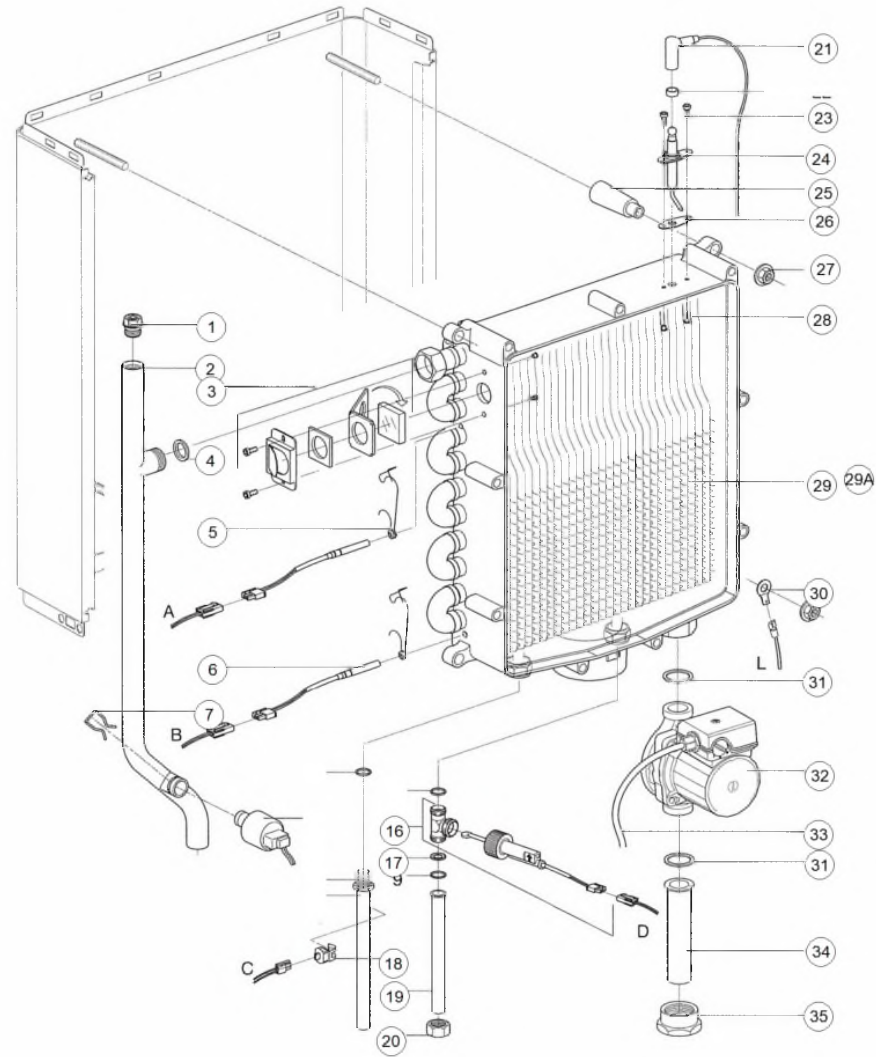





Igniter & hydraulics > HRE-HIP







Igniter & hydraulics > HRE-HiP

| |  | Code | Code GA | Quant. | Photo | Description | Remarque |
|----|--|----------|---------|--------|---|---|---------------|
| 1 | | 91843017 | 785589 | 1 | | Purgeur air 3/8 G | |
| 2 | | 91854627 | | 1 | | Tube départ HRE-HiP | |
| 3 | | 91081097 | 785439 | 1 | | Ensemble regard de flamme (Kompakt) | |
| 4 | | A1002017 | 786805 | 1 | | Joint 3/4 tubes -> échange. HR-HRE | |
| 5 | | 91873337 | 785635 | 2 | | Clip de fixation NTC1&2 HR | |
| 6 | | 91200117 | 785507 | 2 |  | Sonde NTC 1-2 Kompakt | |
| 7 | | 91873537 | 785638 | 1 |  | Clip de fixation pressostat Kompakt HRE | |
| 16 | | 91844267 | 785592 | 1 |  | Flussostat Sika VKX | |
| 17 | | 91829287 | 785576 | 1 | | Limiteur de débit ECS pour HR36/30 | |
| 18 | | 91200177 | 785510 | 1 |  | Sonde NTC 3 12K contact pour tube 15mm | |
| 19 | | 91854527 | 785618 | 1 | | Tube eau froide HRE | |
| 20 | | 91826047 | 785568 | 1 | | Ecrou 1/2 | |
| 21 | | 91074607 | 785429 | 1 |  | Câble allumage HR-HRE | |
| 23 | | 91305137 | 785535 | 2 |  | Vis M4x10 | |
| 24 | | 91209327 | 785511 | 1 | | électrode HR-HRE | |
| 25 | | 91878517 | | 4 | | Entretoise échangeur HRE | |
| 26 | | 91875677 | 785645 | 1 |  | Joint électrode Kompakt | |
| 27 | | A1003932 | 787285 | 4 | | Ecrou M8 auto-blocantes Kompakt | Prev 91313047 |
| 28 | | 91319047 | 785537 | 1 | | Ecrou interne M4 | |
| 29 | | 91147347 | | 1 | | Heat exchanger HRE HiP Kombi | Kombi |



Igniter & hydraulics > HRE-HIP



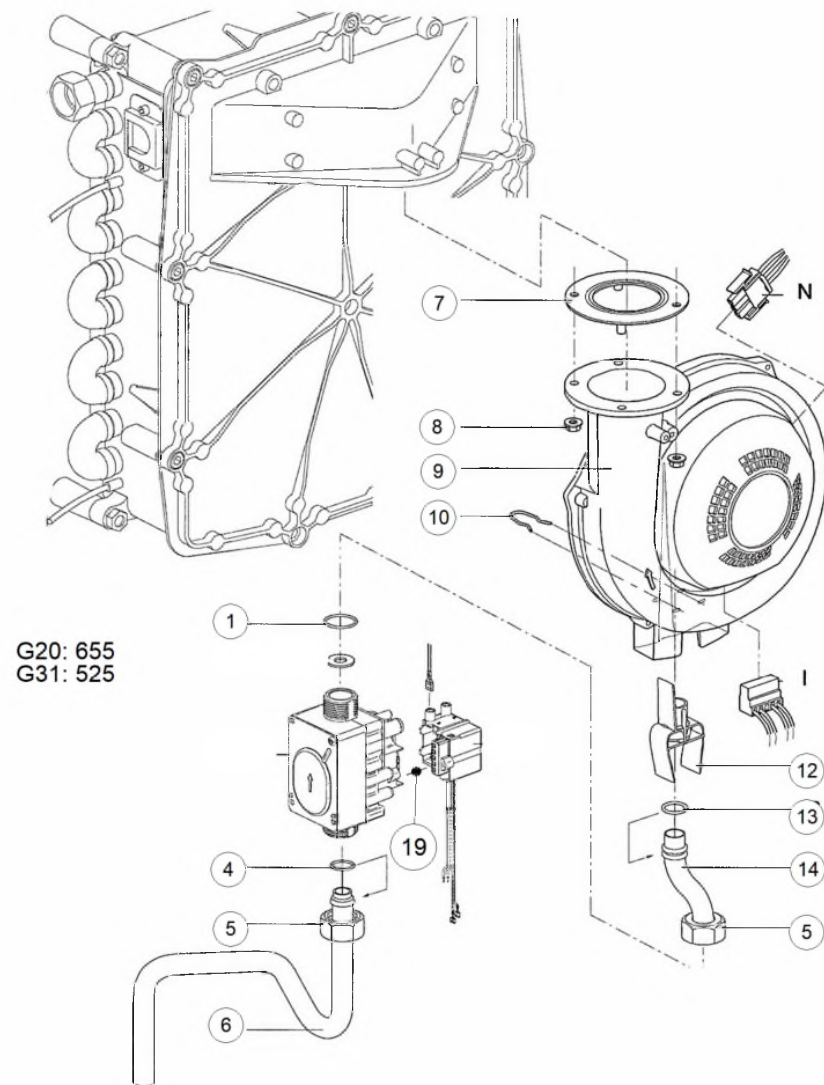

| |  | Code | Code GA | Quant. | Photo | Description | Remarque |
|-----|--|----------|---------|--------|---|-----------------------------|----------|
| 29A | | 91147357 | | 1 | | Heat exchanger HRE HIP Solo | Solo |
| 30 | | 91231107 | | 1 | | Cosse de mise à la terre | |
| 31 | | 91875567 | 785642 | 1 |  | Joint pompe 1" | |
| 32 | | 91210327 | 785514 | 1 |  | Circul.RS15/7-3-130 | |
| 33 | | 91221507 | | 1 | | Câble pompe HRE | |
| 34 | | 91828287 | 785573 | 1 | | Tube retour HRE | |
| 35 | | 91826207 | 785570 | 1 | | Ecrou de pompe 1" HRE | |

Gas line > HRE-HiP





Gas line > HRE-HiP

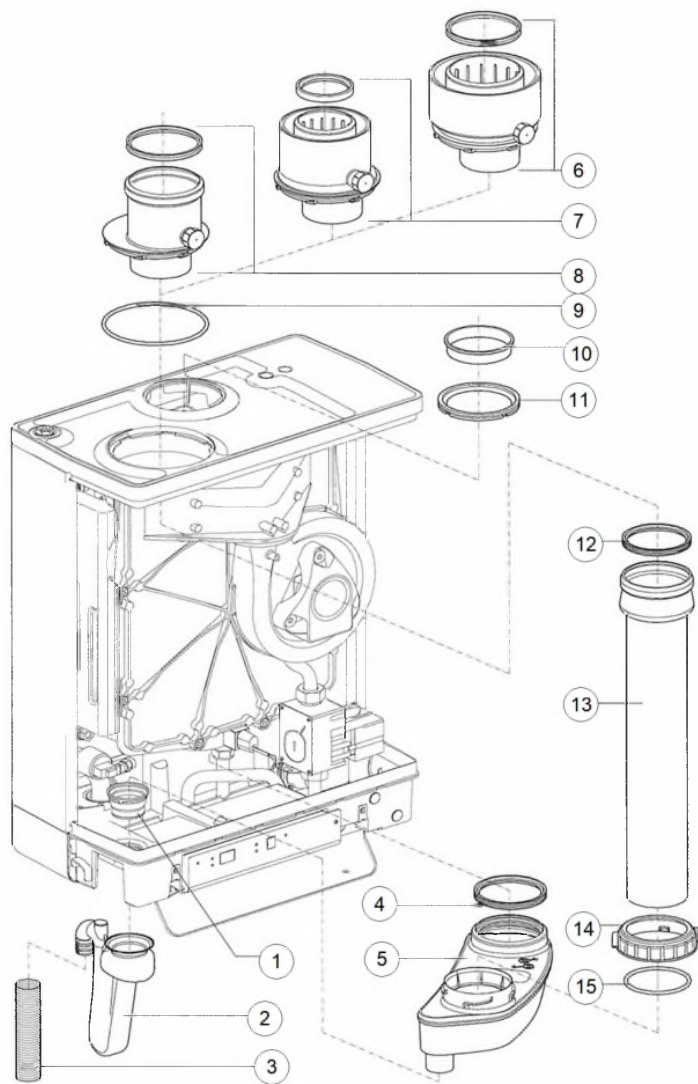

| Code | Code GA | Quant. | Photo | Description | De --- A --- | Remarque |
|------|----------|--------|-------|---|--------------|------------------------|
| 1 | 91875827 | 785649 | 1 |  O-ring 19X2 | | |
| 3 | 91801527 | 785563 | 1 |  Vanne gaz Siemens Smart VGU76s (HR-HRE) | 01-04-13- | together with 91801537 |
| 4 | 91875757 | 785647 | 1 | | | |
| | | | | Joint gaz plat 21.5/15.5 | | |
| 5 | 91826067 | 785569 | 2 | | | |
| | | | | Ecrou 3/4 D:19 | | |
| 6 | 91854937 | | 1 | | | |
| | | | | Tube gaz HRE-HiP L:122 | | |
| 7 | 91877807 | 785663 | 1 |  Joint ventilateur HR-HRE | | |
| 8 | 91312027 | 785536 | 2 | | | |
| | | | | Ecrou épaulé M5 | | |
| 9 | 91074577 | 785428 | 1 |  Kit rempl.ventilateur Torin pr HIP | | |
| 10 | 91873027 | 785634 | 1 | | | |
| | | | | Epingle tube mélange gaz | | |
| 11 | 91801537 | 785564 | 1 |  Transfo allum. HR-HRE TQG43.A2109 Siem. | 01-04-13- | |
| 12 | A1002239 | 786908 | 1 |  Mélangeur air-gaz 362 | | Prev: 91829527 |
| 13 | 91875967 | | 1 | | | |
| | | | | O-ring 15x1.5 NBR 70sh | | |
| 14 | 91854727 | | 1 | | | |
| | | | | Tube de mélange gaz HRE L:111 ->A1002180 | | |

Flue > HRE-HIP





Flue > HRE-HIP

| Id | Code | Code GA | Quant. | Photo | Description |
|----|----------|---------|--------|---|---|
| 7 | 91090547 | 785448 | 1 | | Sortie fumée 60/100 HRE |
| 6 | 91090557 | 785450 | 1 | | Sortie fumée 80/125 HRE |
| 10 | 91490087 | 785546 | 1 | | Bouchon DN80 entrée d'air Kompakt |
| 3 | 91594157 | 785549 | 1 |  | Tuyau cannelé ø25x21 l=600 |
| 2 | 91844187 | 785591 | 1 | | Siphon HRE |
| 13 | 91847027 | 785611 | 1 |  | Tube de fumées 36/30 |
| 5 | 91847037 | 785612 | 1 | | Bac de condensats HRE HIP |
| 14 | 91847057 | 785613 | 1 | | Ecrou serrage tube de fumées HRE |
| 4 | 91878147 | 785669 | 1 | | Joint à lèvres DN76 bac Cond. HRE |
| 11 | 91878387 | 785673 | 1 | | Joint passage tube d'air 90-80 HR-HRE |
| 9 | 91878527 | 785674 | 1 | | O-ring 115x4 |
| 15 | 91878537 | 785675 | 1 |  | O-ring 68x4 |
| 12 | 91878547 | 785676 | 1 | | Joint à lèvres 70x82 HRE |
| 1 | 91878577 | 785677 | 1 | | Joint passage siphon HRE |
| 8 | A1002820 | 787024 | 1 |  | Set sortie fumées DN80 pour Kompakt HRE |



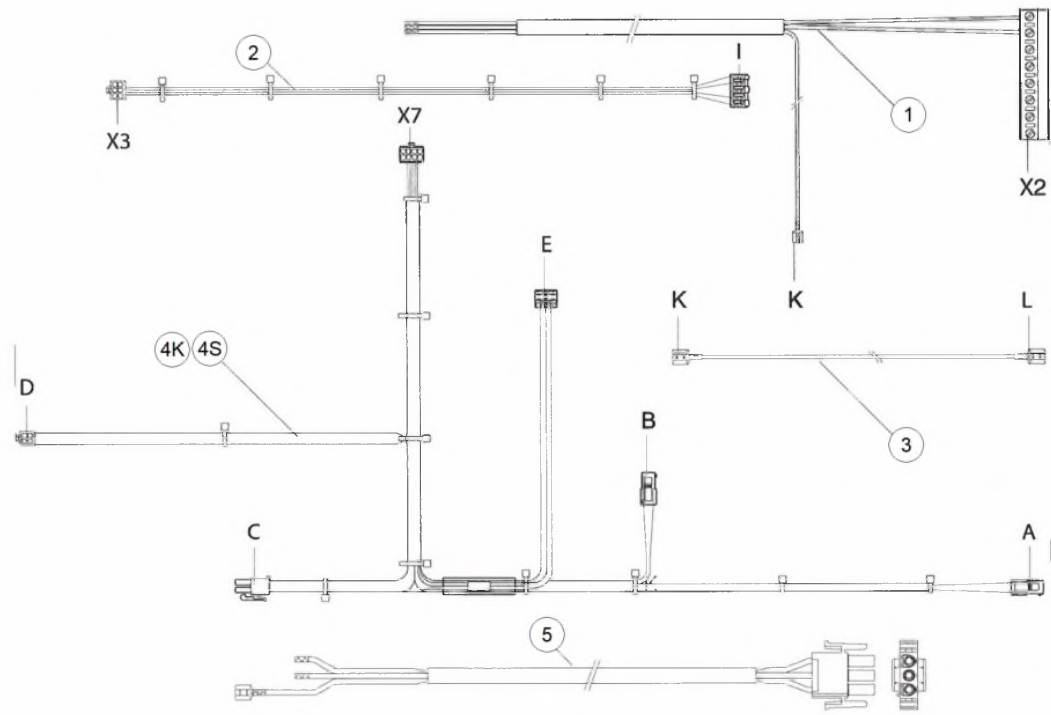

Wiring > HRE-HiP





Wiring > HRE-HiP

| |  | Code | Code GA | Quant. | Photo | Description | Remarque |
|----|--|----------|---------|--------|---|----------------------------|----------|
| 1 | | 91221507 | | 1 | | Câble pompe HRE | |
| 2 | | 91221477 | 785521 | 1 |  | Câble ventilateur HRE | |
| 3 | | 91221437 | 785519 | 1 | | Câble de terre HR-HRE | |
| 4K | | 91221487 | 785522 | 1 | | Câblage NTC Kombi HRE | Kombi |
| 4S | | 91221497 | 785523 | 1 | | Câblage NTC Solo HRE | Solo |
| 5 | | 91221557 | | 1 | | Câble 230V ventilateur HRE | |