

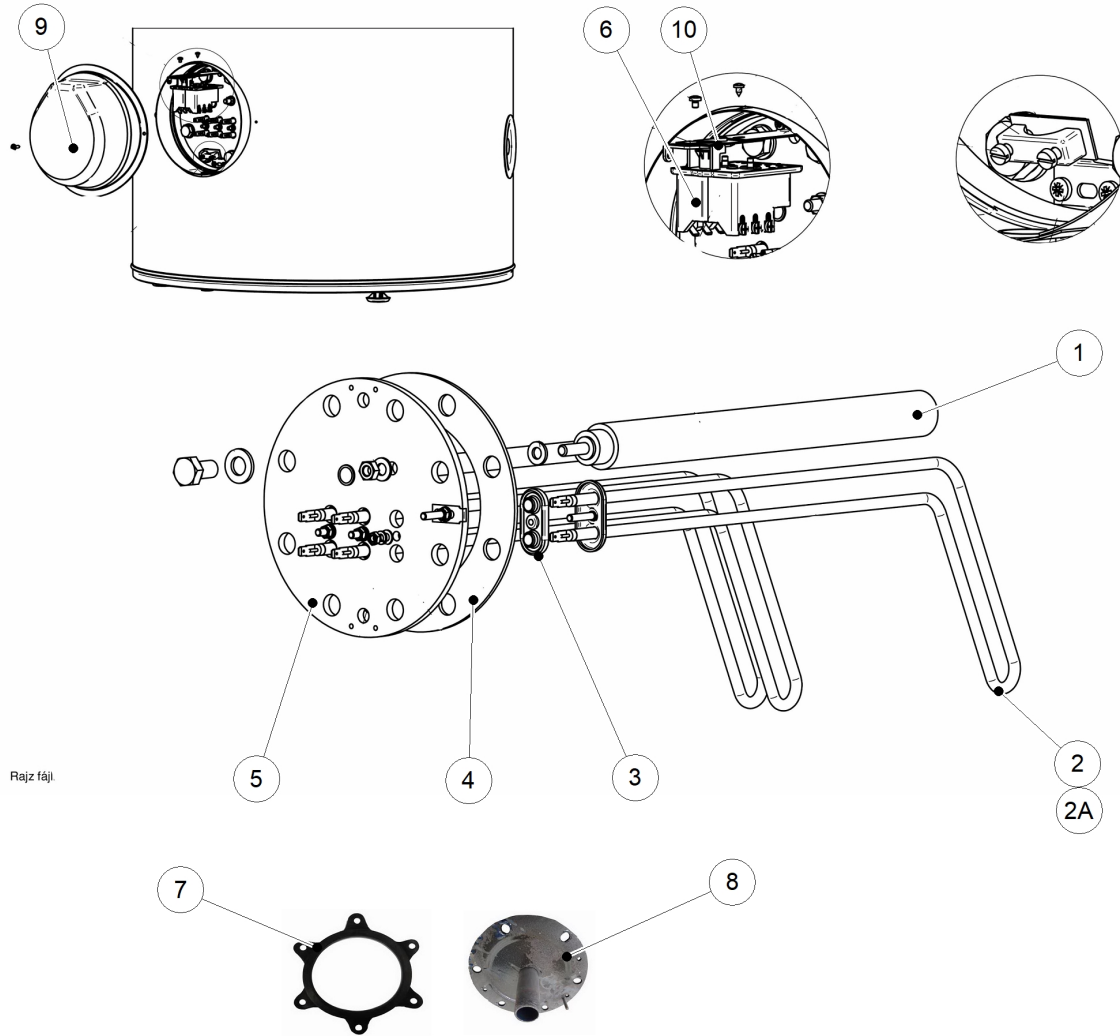







Glass BL-S mono(3) floor V17



Rajz fájl



Glass BL-S mono(3) floor V17

Code	Code GA	Quant.	Photo	Description	De --- A ---	Remarque
1	90021033	785358	1	 Anode (32x270)+joint Glass150-200-300	01-05-18-	
2A	90016036	785355	1	 Resist.chauff.BL 600W pliée	01-05-18-	BL 150S
2	A1005378	002447	3	Resist.chauff.BL-S 800W pliée Glass ERP	01-05-18-	BL 200S
3	90052041	785377	1	 Joint resist.chauff.BL Glass	01-05-18-	
4	90044502	785374	1	 Joint de bride montage socle Glass	01-05-18-	
5	A1005377	595002	1	Bride BL sol tri Glass ERP	01-05-18-	Not compatible prev.versions
6	90057626	785379	1	 T-stat (tri) BTS5005 Glass	01-05-18-	
7	90027044	785360	1	 Joint de bride emboutie Glass	01-05-18-	
8	90009007	785347	1	 Tuyau/bride dép.ECS Glass 150-200S	01-05-18-	
9	A1005379		1	Capot BL-ST vertical blanc Glass ERP	01-05-18-	
10	A1005380		1	Support T-stat BTS Glass ERP	01-05-18-	