

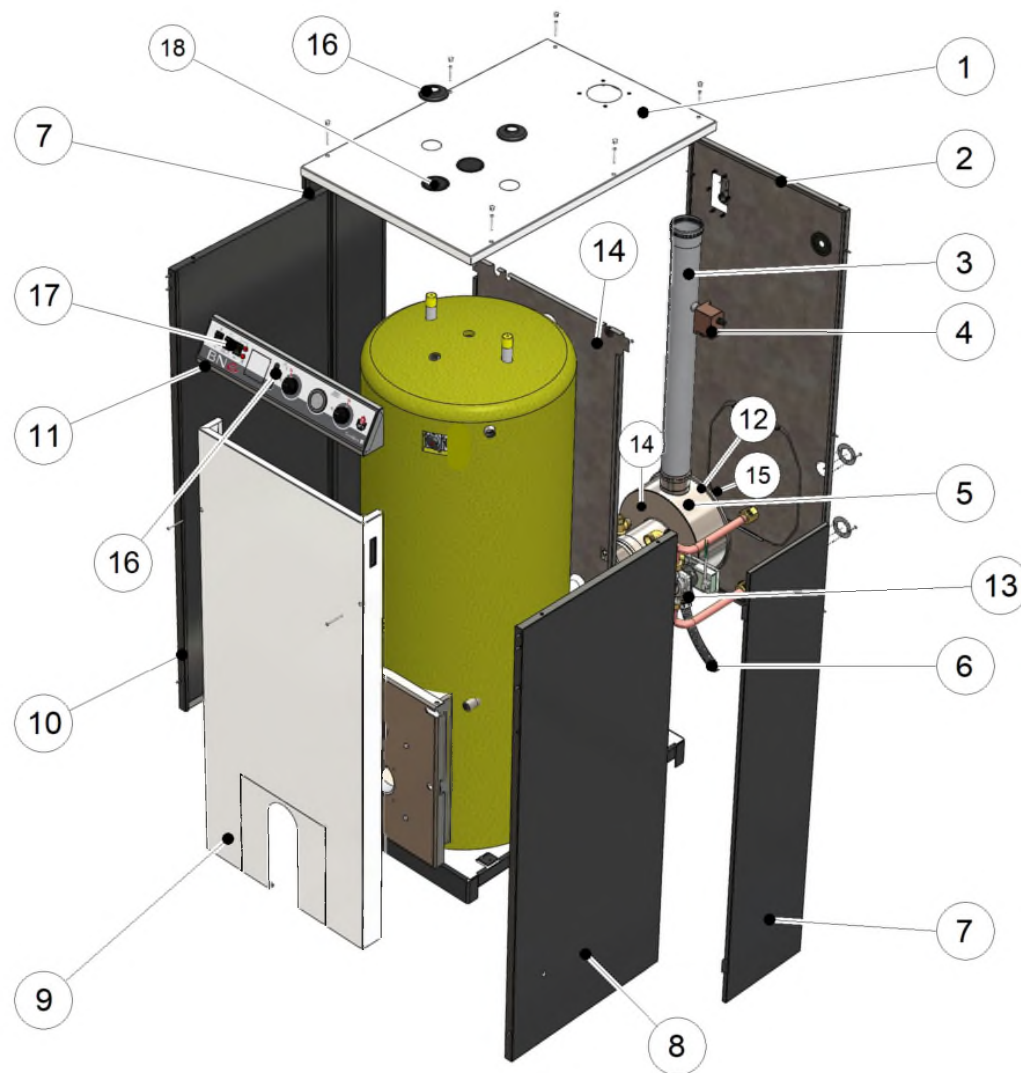







## Panels BNE2 Condens





## Panels BNE2 Condens





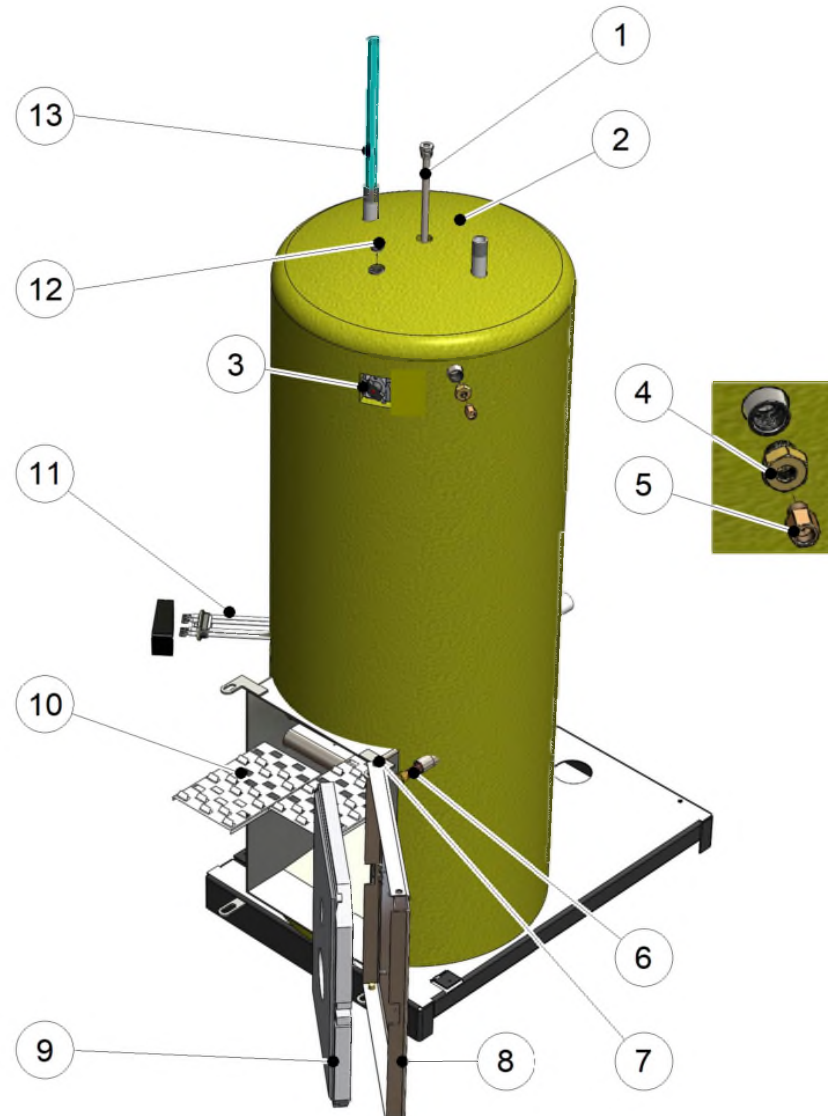





Code	Code GA	Quant.	Photo	Description	De --- A ---	Remarque	
1	28067061	1		supérieur BNE2 Condens	01-06-13-		
2	28067064	1		Arrière BNE2 Condens	01-06-13-		
3	497B6038	785919	1	Tube fumée BNE2 Condens + joint	01-06-13-		
4	54764031	785219	1	T-stat (fumées) cut-off 110°C TS-RM-B	01-06-13-		
5	08625901	784334	1	Echangeur complet N2 Condens	01-06-13-		
6	537D8200	1		Siphon échangeur N-BNE2 Condens	01-04-15-		
7	28067066	590050	2	Lat G/D Arrière BNE2 Condens	01-06-13-		
8	28067062	784747	1	Lat.droit BNE2 Condens	01-06-13-		
9	28067060		1	Avant BNE2 Condens	01-06-13-		
10	28067063	590049	1	Lat.gauche avant BNE2 Condens	01-06-13-		
11	28067059	784746	1	Tableau BNE2 Condens	01-06-13-		
12	537D8201	786422	1		O-ring échang.N-BNE2 condens	01-04-15-	
13	557A4029	786710	1		Circul.Yonos Para RS15 L130-3 G1 RKARKC	01-06-13-	Class A
14	51700192		1		Isol.entrée échangeur N-BNE2condens	01-04-15-	
15	51700193	785020	1		Isol.Arrière échangeur N-BNE2condens	01-04-15-	
16	54763007	785196	1		Thermomètre vertical	01-06-13-	sanit.
17	54766013	785231	3		Interrupt.noir 22x30 dbl.inv 6cont.	01-06-13-	On/off & Summer/Wintert & Energy select
18	49430026	784905	1		Bouchon 61.3mm PVC noir (fine tôle)	01-06-18-	

Internal BNE2 Condens





Internal BNE2 Condens

Code	Code GA	Quant.	Photo	Description	De --- A ---	Remarque
1	39438023	784820	1	 Doigt de gant inox 1/2x350		
2	30540611		1	 Corps moussé BNE2 Condens		
3	54764034	785222	1	 T-stat+reset 90°C 2pole (type TOD)	01-10-13-	Prev: 54764010
4	43416065	784848	1	Réduction mf 1/2 x 1/4 laiton		
5	557A5005	786717	1	 Raccord manomètre 1/4 +clap.AR		
6	63438001	785296	1	 Doigt de gant laiton 1/2x100 3 bulbes		
7	47405252	784869	2	 Pivot charnière porte M10 19x33 Laiton		
9	51700112		1	Isol. (bio) porte N2-BNE2		
10	50423097	784914	6	 Chicane N/BNE0-1-2+ CU N2 247x157		
11	54428182	785149	7	 Resist.chauff. 2 x 2,4kW		
12	55445006	785282	1	 Purgeur air man.1/2		
13	49410045	784899	1	 Plonge PVCc 19,5x800 ouverte		