

Smart 100-240 incl.Green

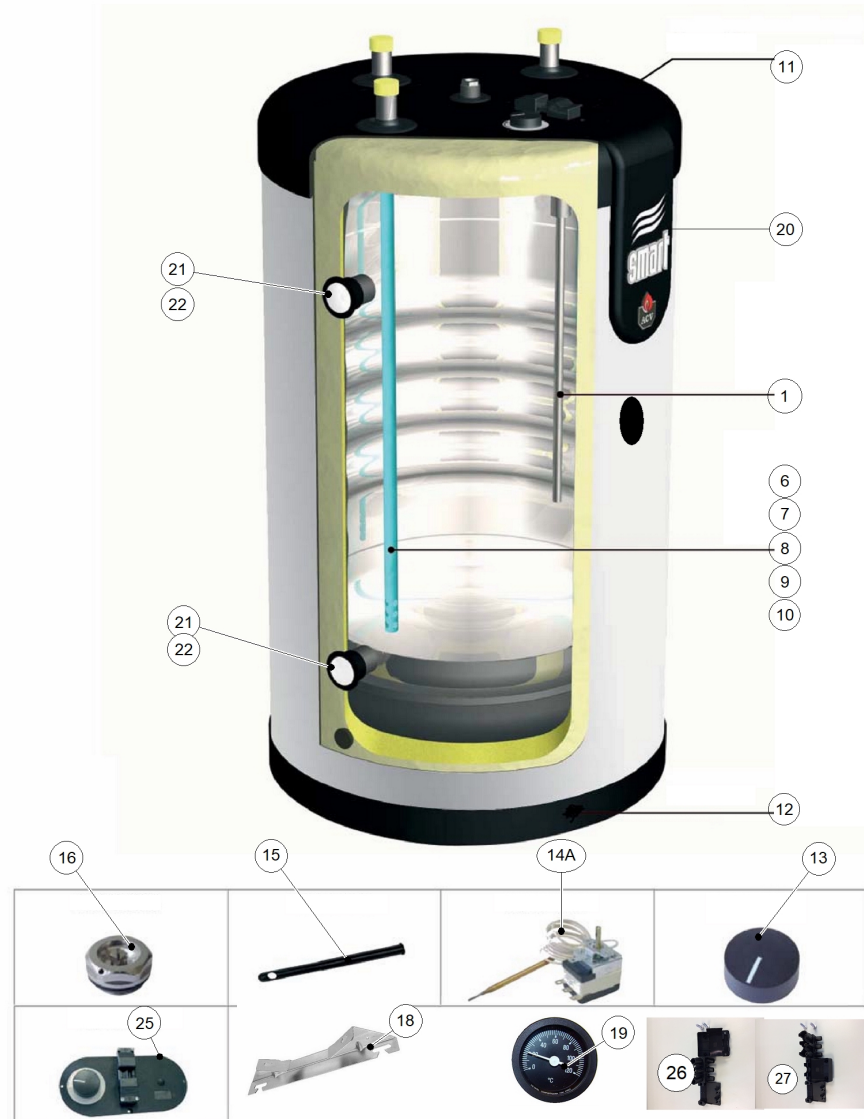



Smart 100-240 incl.Green

Code	Code GA	Quant.	Photo	Description	De --- A ---	Remarque
1	39438027	784821	1	Doigt de gant inox 1/2x500		
6	497B0003	785849	1	Plonge PVCc 19,5x700 perç.lat.		SL100
7	497B0051	785865	1	Plonge PVCc 19,5x840 perç.lat.	01-07-14-	SL130
8	497B0006	785852	1	Plonge PVCc 19,5x1000 perç.lat.	01-07-14-	SL160
9	497B0027	785856	1	Plonge PVCc 19,5x1280 perç.lat.	01-07-14-	SL210
10	497B0028	785857	1	Plonge PVCc 19,5x1540 perç.lat.	01-07-14-	SL240
11	497B5010	785900	1	Calotte supérieure Smart STD 100-240		
12	A1003197	787146	1	Calotte inférieure Smart 100 -> 240 V08	01-11-16-	PREV 497B5015
13	54764021	785212	1	Bouton rotatif thermostat-trait blanc		
14A	A1002038	786807	1	T-stat 0-80°C cap1500 bulb6 TU-L-DT	01-01-16-	prev 54442045
15	A1002643	787012	1	Brise jet Ø19.5 L 280	01-12-16-	PREV 49410036
16	55445006	785282	1	Purgeur air man.1/2		
18	50423201	784918	2	Fixation murale HL-ECO-Smart-Comfort		
19	54763020	785204	1	Thermomètre 0-120°C Dp:52 SmartLine	01-07-12-	
20	497B4001	788147	1	Support logo SMART Line 100-240-320		
21	49410069	784900	2	Bague de retenue manchon 4/4		SL100-130-160
22	49410201	784903	2	Bague de retenue manchon 5/4		SL210-240
25	A1002069	786815	1	Support câblé Smart 100->240 V15	01-01-16-	prev 24614154
26	54428130	785145	1	Prise M. 3 pôles		
27	54428131	785146	1	Prise F. 3 pôles		



Smart 100-240 incl.Green

Code	Code GA	Quant.	Photo	Description	De --- A ---	Remarque
90 60772080	788131	1		Cardboard box SL 100		Smart 100
90 60772081	788132	1		Cardboard box SL 130		Smart 130
90 60772082	788133	1		Cardboard box SL 160		Smart 160
90 60772083	788134	1		boîte Smart 210		Smart 210
90 60772084	788135	1		Cardboard box SL 240		Smart 240
90 60772086	200029	1		Fond Emballage Smart standard		All Smart & Smart green