

# MURAL

## RPK-0.8FSNH4M

Pièces détachées

Main view

### LOCATION OF SERVICE PARTS IN THE UNIT

MODEL: RPK-0.4FSNH4M  
RPK-0.6FSNH4M  
RPK-0.8FSNH4M  
RPK-1.0FSNH4M

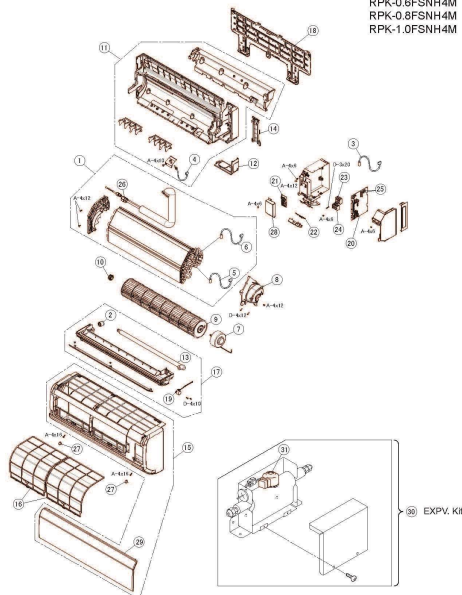

A	Triax Head Tapping Screw	3-3550	F	Ball Nut	HC-38
B	Round Head Screw	3-4000	G	Nut	(2)
C	Flat Head Screw	3-4000	H	Washer	(2)
D	Triax Head Tapping Screw	3-3550	J	Spring Lock Washer	(2)
E	Hexagon Head Bolt	3-4000	K	Notched Lock Washer	(2)

NOTE:  
This environmental coating is applied to iron and steel materials for the unpainted materials of this set and below.

NOTE:  
The parts without order number are the custom-ordered, and these are not mentioned in the price list.  
When ordering them, the part name and the drawing number are required.  
Contact your HITACHI distributor for the delivery date and price about them.

- 8 -

© 2018 Hitachi-Johnson Controls Air-Conditioning, Inc.

Rep. Référence

Description

Qté

Remarques

# MURAL

## RPK-0.8FSNH4M

1	P31729	HEAT EXCHANGER	1	
2	P27062	Drain Cap	1	
3	P24016	THERMISTOR	1	THM1 for Air Inlet
4	P29626	Thermistor Air Outlet	1	THM2 for Air Outlet
5	P29628	Thermistor Freeze Protection	1	THM3 for Freeze Protection
6	P29627	Thermistor THM5 for Gas Line	1	THM5 for Gas Line
7	P29608	Fan Motor	1	DC, 38W
8	P29609	Motor Clamp	1	
9	P29610	Fan	1	
10	P26601	BEARING	1	
11	P29612	Bottom Base	1	
12	P29614	Corner Cover	1	
13	P29615	Drain Hose	1	
14	P29616	Pipe Cover	1	
15	P29636	Cabinet Panel Assy	1	Including part No. 29 Flat Panel
16	P31599	FILTER	2	
17	P29621	Drain Pan Assy	1	
18	P29623	Plate	1	
19	P29624	As Motor	1	for Auto Swing Louver
20	P31924	PCB-S	1	PI-151-S for Control
21	P31925	PCB-S	1	for Switch
22	P29625	PCB-S	1	for Receiver with Indicator
23	P26616	TERMINAL BLOCK	1	for Power Source Circuit
24	P26618	TERMINAL BLOCK	1	for Control Circuit
25	P27957	FUSE	2	Fuse on PI-151-S, 5A
26	R4226	Flare Nut	1	12.7
27	P29629	Screw Cap	2	
28	P29709	SWITCH COVER	1	
29	P29698	FLAT PANEL	1	with "HITACHI" Logo
30	P29781	EXPANSION VALVE	1	Fujikoki Corporation, PAM-B40YGHS-1
31	P29630	Motor for ExPV	1	Included in part No. 30 EXPV. Kit