

INITIA

Repère	Référence	Désignation	Quantité
1	SX5653140	CHASSIS MONTANT VERTICAL (5653140)	1,0000
2	SX5653630	PANNEAU COTE GAUCHE H=763 (5653630)	1,0000
2	SX5681390	PANNEAU COTE GAUCHE	1,0000
3	SX5653620	PANNEAU COTE DROIT H=763 (5653620)	1,0000
4	SX5113430	PANNEAU AVANT FI	1,0000
5	SX5110290	TRAVERSE ARRIERE SUPERIEURE (5110290)	1,0000
6	SX5109640	TRAVERSE ARRIERE INFERIEURE (5109640)	1,0000
8	SX5408080	TUBE SILICONE PRESSOSTAT 4,8X8 L=270 (x4) (5408080)	1,0000
9	SX5108700	DIAPHRAGME D:80 (PDM5108700)	1,0000
10	SX5207060	RACCORDEMENT VENTOUSE (5207060)	1,0000
11	SX5407890	JOINT VENTOUSE CAOUTCHOUC (5407890)	1,0000
12	SX5108690	OBTURATEUR (5108690)	1,0000
13	SX5407400	JOINT OBTURATEUR DECOUPE (x3)	1,0000
15	SX0600530	COLLIER SORTIE EXTRACTEUR (0600530)	1,0000
17	SX5211090	COUDE (5211090)	1,0000
18	SX5407050	VENTURI (5407050)	1,0000
21	SX5402050	JOINT 6,1x11,5x1,5 (X3)	1,0000
22	SX5653850	EXTRACTEUR 1V MVL RLG108 (5653850)	1,0000
23	SX0618470	PRESSOSTAT 1,2MB HONEYWELL	1,0000
23	SX5629560	PRESSOSTAT HONEYWELL (5629560)	1,0000
23	SX5655120	PRESSOSTAT(TRIDELTA) (5655120)	1,0000
24	SX5407930	TUBE SILICONE PRISE LG.150 (5407930)	1,0000
24	SX5414320	TUBE PRISE DE COMPENSAT.L=170	1,0000
25	SX5653170	HOTTE D'EVACUATION DES FUMES (5653170)	1,0000
27	SX0618840	CHAMBRE DE COMBUSTION (FF)	1,0000
27	SX5653780	CHAMBRE ETANCHE (5653780)	1,0000
28	SX5210250	PANNEAU ISOLANT LATERAL (5210250)	1,0000
28	SX5213160	PANNEAU ISOLANT LATERAL (5213160)	1,0000
29	SX5210260	PANNEAU ISOL.ARRIERE(5210260)	1,0000
29	SX5213290	PANNEAU ISOLANT ARRIERE 32KW (5213290)	1,0000
30	SX5210750	PANNEAU ISOLANT AVANT (5210750)	1,0000
30	SX5213340	PANNEAU ISOLANT AVANT (5213340)	1,0000
31	SX5111840	PANNEAU AVANT CHAMBRE COMBUSTION (5111840)	1,0000

INITIA

Repère	Référence	Désignation	Quantité
32	SX0603280	ECHANGEUR PRINCIPAL (603280)	1,0000
32	SX5632470	ECHANGEUR PRINCIPAL 23KW (PDM5632470)	1,0000
33	SX5403130	O-RING 22X3 EPDM (x3) (5403130)	1,0000
34	SX5112510	CLIP FIXATION ECHANGEUR PRIMAIRE (5112510)	1,0000
35	SX5659020	VASE D'EXPANSION (5659020)	1,0000
36	SX5653290	TUBE VASE D'EXPANSION (5653290)	1,0000
37	SX5653710	PANNEAU AVANT CHAMBRE ETANCHE (5653710)	1,0000
38	SX5401610	JOINT HUBLOT (x3) (5401610)	1,0000
39	SX5203930	HUBLOT (5203930)	1,0000
40	SX5103360	COUVERCLE HUBLOT (5103360)	1,0000
41	SX5653310	BRULEUR 12 BECS (5653310)	1,0000
42	SX5604090	ELEMENT BRULEUR (5604090)	1,0000
43	SX0605850	NOURRICE PORTE-INJECTEUR 12T.D.1,28 (605850)	1,0000
43	SX0605990	NOURRICE PORTE-INJECTEUR 12T.D.0,77 (605990)	1,0000
44	SX0608430	KIT INJECTEURS D.1,28 GN (608430)	1,0000
44	SX0608450	KIT INJECTEURS D.0,77 BP (608450)	1,0000
45	SX5407940	JOINT NOURRICE (x3) (5407940)	1,0000
46	SX5657180	RACCORD NOURRICE (5657180)	1,0000
47	SX5407810	JOINT NOURRICE/CAISSON (5407810)	1,0000
49	SX5207070	BOUCHON RACCORDEMENT VENTOUSE (5207070)	1,0000
59	SX8419050	CABLE ELECTRODE D'ALLUMAGE (x2) (8419050)	1,0000
61	SX5407830	PROTECTION ELECTRODE (x3) (5407830)	1,0000
62	SX5409570	PRISE DE PRESSION FF (5409570)	1,0000
62	SX5643090	RACCORD PRISE DE PRESSION (5643090)	1,0000
63	SX8422570	ELECTRODE ALLUMAGE (x4) (8422570)	1,0000
65	SX8423300	ELECTRODE IONISATION LUNA 2.24 FF ET 1.24 FF	1,0000
70	SX5653250	TUBE POMPE ECHANGEUR (5653250)	1,0000
70	SX5688840	TUBE POMPE/ECHANGEUR	1,0000
72	SX5655200	POMPE GRUNDFOS 15/50 (5655200)	1,0000
73	SX0607290	DEGAZEUR (607290)	1,0000
74	SX5406360	O-RING 14X1,78 (x3)	1,0000
75	SX5404670	JOINT TUBE/CAISSON (x3) (PDM5404670)	1,0000
76	SX5653650	ECHANGEUR SANITAIRE ALFA LAVAL (5653650)	1,0000
76	SX5686660	ECHANGEUR SANITAIRE (5686660)	1,0000

INITIA

Repère	Référence	Désignation	Quantité
77	SX5404520	JOINT ECHANGEUR SANITAIRE(x4) (PDM5404520)	1,0000
80	SX5659040	GROUPE ENTREE SANITAIRE/RETOUR CHAUFFAGE (5659040)	1,0000
81	SX5652270	GROUPE FILTRE/VENTURI SANITAIRE (5652270)	1,0000
82	SX5630170	VENTURI ECS (PDM5630170)	1,0000
83	SX5629240	LIMITEUR DEBIT SANIT.8L/MN	1,0000
84	SX5111180	FILTRE SANITAIRE (x3) (PDM5111180)	1,0000
85	SX5405350	JOINT O-RING FILTRE SANITAIRE (x3) (PDM5405350)	1,0000
87	SX5210710	ELEMENT DE CONNEXION POMPE (5210710)	1,0000
90	SX5630180	ROBINET DE REMPLISSAGE	1,0000
91	SX5652030	ROBINET DE VIDANGE (PDM5652030)	1,0000
92	SX9951170	SOUPAPE DE SECURITE 3BARS (9951170)	1,0000
96	SX5653280	TUBE PRESSION + (5653280)	1,0000
97	SX5653270	TUBE PRESSION - (5653270)	1,0000
98	SX5653260	TUBE BY-PASS (5653260)	1,0000
99	SX5108130	CLIP TUBE DE BY-PASS (PDM5108130)	1,0000
100	SX5406630	JOINT D=13,94x2,62 (x3) (PDM5406630)	1,0000
101	SX5653590	GROUPE V3V PRESSOSTAT SANITAIRE (5653590)	1,0000
102	SX0607250	VANNE 3 VOIES (607250)	1,0000
103	SX5629950	PRESSOSTAT SANITAIRE (PDM5629950)	1,0000
104	SX5657290	CONNEXION SORTIE SANITAIRE (5657290)	1,0000
106	SX8101430	VIS M5X12 (8101430)	1,0000
107	SX5630250	ENSEMBLE RACCORD (5630250)	1,0000
108	SX8101420	VIS M4X12 (8101420)	1,0000
109	SX5207810	JOINT (x3) (5207810)	1,0000
110	SX8380530	RESSORT DEBIT D'EAU (8380530)	1,0000
111	SX5630240	PLATEAU SECURITE D'EAU (5630240)	1,0000
112	SX5405320	MEMBRANE SECURITE DEBIT D'EAU (x3) (PDM5405320)	1,0000
113	SX5630190	GROUPE BY-PASS (PDM5630190)	1,0000
114	SX5403820	JOINT O-RING (x3) (5403820)	1,0000
115	SX5645660	GROUPE OBTUR.BY-PASS (5645660)	1,0000
117	SX5646180	BOUCHON AVANT (5646180)	1,0000
118	SX8380520	RESSORT BY-PASS (8380520)	1,0000
119	SX5646170	CLAPET CHAUFFAGE V3V (PDM5646170)	1,0000

INITIA

Repère	Référence	Désignation	Quantité
120	SX5646190	BOUCHON PRESSOSTAT SANITAIRE	1,0000
121	SX8101410	VIS INOX M5X10 (8101410)	1,0000
122	SX5405370	O-RING "FILTRE SANITAIRE" (x3) (5405370)	1,0000
123	SX8101440	VIS M5X13 (8101440)	1,0000
124	SX8380540	RESSORT PRESSOSTAT SANITAIRE (8380540)	1,0000
125	SX5630260	GOUJON SANITAIRE (5630260)	1,0000
126	SX5630270	PLATEAU SECURITE DEBIT SANITAIRE (5630270)	1,0000
127	SX5405330	MEMBRANE PRESSOSTAT SANITAIRE (x3) (PDM5405330)	1,0000
128	SX5405400	JOINT (x3) (5405400)	1,0000
129	SX5207860	CLIQUET (5207860)	1,0000
130	SX5625770	MICRO-INTERRUPTEUR (x4) (PDM5625770)	1,0000
131	SX8434250	SONDE NTC (8434250)	1,0000
131	SX8434820	SONDE CTN CH et SN MURALE (8434820)	1,0000
132	SX5402830	JOINT SONDE SANITAIRE (X10) (PDM5402830)	1,0000
134	SX5211170	DIAPHRAGME GAZ 4,7mm (5211170)	1,0000
135	SX9950760	SECURITE SURCHAUFFE 105° (9950760)	1,0000
136	SX5653240	TUBE V3V/ECHANGEUR (5653240)	1,0000
137	SX0610080	TUBE GAZ (610080)	1,0000
138	SX5402010	JOINT O-RING (x3) (PDM5402010)	1,0000
139	SX5210630	RACCORD ENTREE GAZ ((5210630)	1,0000
140	SX5653610	VANNE GAZ SIT (845 SIGMA)	1,0000
147	SX5653160	TRAVERSE PLATINE HYDRAULIQUE (5653160)	1,0000
151	SX5407650	COUVERCLE BOITIER ELECTRIQUE (5407650)	1,0000
152	SX5662450	PANNEAU DE CDE INITIA 2,24FF	1,0000
153	SX5407660	COUVERCLE BRANCHE.ELECTRIQUE (5407660)	1,0000
154	SX5653890	CIRCUIT IMPRIME IONISATION "INECO" (5653890)	1,0000
166	SX8421590	BORNIER DE RACCORDEMENT (PDM8421590)	1,0000
167	SX5405340	PORTE-FUSIBLES (x3) (PDM5405340)	1,0000
168	SX8421410	FUSIBLE 2A (x10) (PDM8421410)	1,0000
169	SX8922380	THERMOMANOMETRE (8922380)	1,0000
170	SX5407750	SUPPORT MANOMETRE (5407750)	1,0000
174	SX5407730	BOUTON POTENTIOMETRE ECO 2000 (5407730)	1,0000
190	SX5404970	JOINT 3/8" (x10) (PDM5404970)	1,0000
192	SX5404650	JOINT G3/4" 17x24x2 (X10) #	1,0000

INITIA

Repère	Référence	Désignation	Quantité
234	SX5657580	TUBE DISCONNECTEUR WATTS (5657580)	1,0000
236	SX5658650	DISCONNECTEUR WATTS(jjj005658650)	1,0000
240	SX0608980	CLAPET AVEC RACCORD ET O-RING (608980)	1,0000
252	SX8434550	SELECTEUR (x2) (8434550)	1,0000
280	SX5207730	JOINT 14,2X18X1,5 AL-18 (x3) (5207730)	1,0000
284	SX5405990	PISTON POTENTIOMETRE (5405990)	1,0000
314	SX8418870	CABLE ELECTRODE D'IONISATION (x2) (8418870)	1,0000
322	SX5102970	CLIPS FIX.BOULE THERMOMETRE (5102970)	1,0000
362	SX0607470	GROUPE CABLES MICRO (607470)	1,0000
363	SX5405390	JOINT O-RING D=13,60x2,7 (x3) (5405390)	1,0000
364	SX5209600	BOUCHON G 1/8" (5209600)	1,0000
493	SX0605660	MANETTE ROBINET REMPLISSAGE	1,0000
496	SX0400020	O-RING 2062 (x3) (400020)	1,0000
511	SX5404600	O-RING 17,86X2,62 (X3)	1,0000
516	SX5210670	PISTON (5210670)	1,0000
517	SX5407840	CLIP FIXATION TUBE (5407840)	1,0000
518	SX5112040	CHEVILLE PANNEAU COMMANDE (5112040)	1,0000
519	SX5407770	LED (5407770)	1,0000
520	SX5112050	VOLET (5112050)	1,0000
521	SX8380730	RESSORT FIXATION VOLET (8380730)	1,0000
525	SX8419060	ALLUMEUR NAC-SIT (8419060)	1,0000
600	SX5112530	RESSORT FIXATION DISCONNECTEUR (5112530)	1,0000
601	SX5408560	O-RING 8,73X1,78 (x3) (5408560)	1,0000
999	SX5407980	JOINT POUR ALLUMEUR NAC SIT (x3) (5407980)	1,0000
999	SX5654000	CABLE M2 CTN-PRESS-SECU	1,0000
999	SX8414620	CABLE M1 ALIM ELEC (8414620)	1,0000
999	SX8418860	CONNECTEUR PONT TIMER (8418860)	1,0000
999	SX8418950	CABLE M1 INTERUPTEUR (8418950)	1,0000
999	SX8510940	CABLE M5/EXTRC-PRESS B&P	1,0000
999	SX8510960	CABLE M7/MODULATEUR B&P	1,0000



INITIA FF

N° 1295	CPB436243251	INITIA 2.24 FF	Tab 174
---------	--------------	----------------	---------

Tab 174

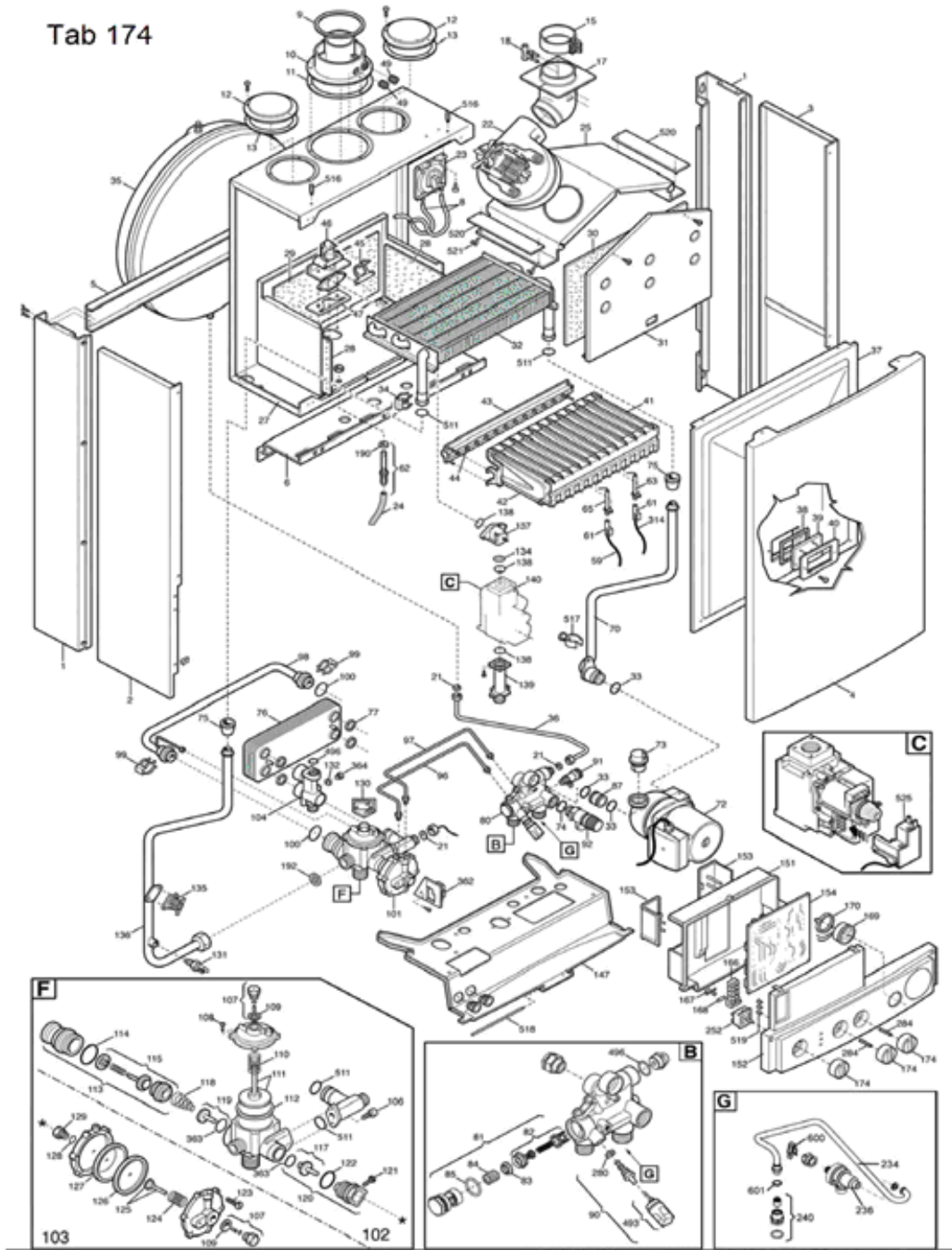

CPN436243071 - INITIA 2.24 FF - Tab 174_V0E