

# SPARE PARTS EXPLODED VIEW GAS WALL BOILERS

Model

## **PIGMA**

R8203109-05 - 23/03/2012

1	3650212	PIGMA 25 CF N FR	...	...
1	3650213	PIGMA 25 CF B/P FR	...	...
2	3650214	PIGMA 25 VMC FR	...	...
3	3650215	PIGMA 25 FF N FR	01/08	...
3	3650216	PIGMA 25 FF B/P FR	...	...
4	3650217	PIGMA 30 FF N FR	...	...
Col	Reference	Model type	Begin	End

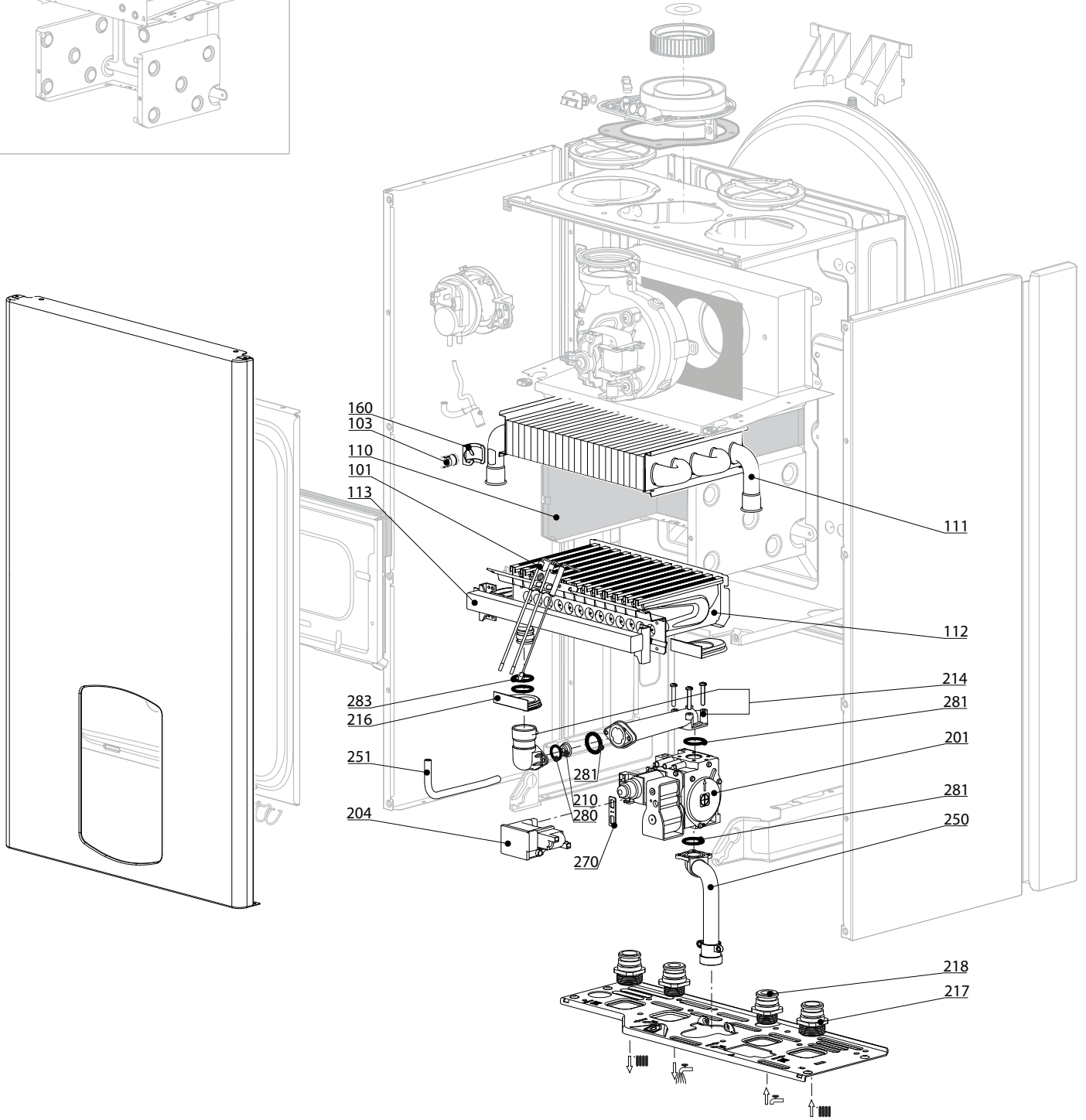
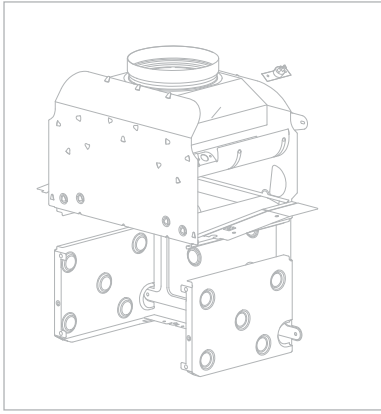

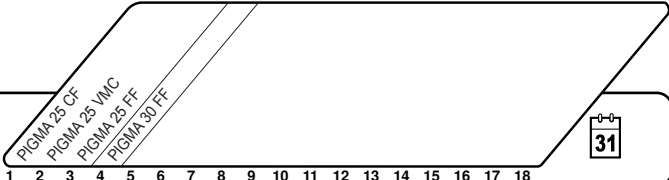
Description	Manf. Pt. N	Type																		
			1	2	3	4	5	6	7	8	9	10	11	12	13	14	15	16	17	18
<b>0100 BURNER ASSEMBLY</b>																				
0101 ELECTRODE (IGNITION/DETECTION)	65104549		•	•	•	•														
0103 THERMOSTAT 102°	65104500		•	•	•	•														
0110 PANELS (KIT)	65104695				•														02/08	
PANELS (KIT)	65104695		•	•		•														
PANELS (KIT)	65106298				•														03/08	
0111 MAIN EXCHANGER	65104246				•														02/08	
MAIN EXCHANGER	65104246					•														
MAIN EXCHANGER	65104247		•	•																
MAIN EXCHANGER	65106297				•														03/08	
0112 BURNER 13NP	65104220				•														02/08	
BURNER 13NP	65104220		•	•		•														
BURNER 11NP	65106294				•														03/08	
0113 GAS MANIFOLD 13 INJ. D:0.76	65104223	B/P			•														02/08	
GAS MANIFOLD 13 INJ. D:0.76	65104223	B/P	•																	
GAS MANIFOLD 11 INJ. D:0.80	65106605	B/P			•														03/08	
GAS MANIFOLD 13 INJ. D:1.32	65104226	NAT				•														
GAS MANIFOLD 13 INJ. D:1.25	65104302	NAT			•														02/08	
GAS MANIFOLD 13 INJ. D:1.25	65104302	NAT	•	•																
GAS MANIFOLD 11 INJ. D:1.32	65106302	NAT			•														03/08	
0160 CLIP	61010050		•	•	•	•														
<b>0200 GAS SECTION</b>																				
0201 GAS VALVE	65104254		•	•	•	•														
0204 SPARK GENERATOR	65104653		•	•	•	•														
0210 RESTRICTOR D: 6.3	60000018	NAT			•														02/08	
RESTRICTOR D: 6.3	60000018	NAT	•	•																
RESTRICTOR D: 5.7	60000498	NAT			•														03/08	
RESTRICTOR D: 7	65105152	NAT				•														
0214 PIPE (GAS VALVE/BURNER)	65104230		•	•	•	•														
0216 GROMMET	60000624		•	•	•	•														
0217 UNION (3/4)	65104326		•	•	•	•														
0218 UNION (1/2)	65104327		•	•	•	•														
0250 GAS TUBE	60000720		•	•	•	•														
0251 EPDM PIPE	65104296				•	•														
0270 GASKET (SPARK GENERATOR)	574279		•	•	•	•														
0280 O-RING D: 14-2.00	60000903	NAT	•	•	•	•														
0281 O-RING 22,22X2,62	65104304		•	•	•	•														
0283 O-RING 17,17X1,78	65104303		•	•	•	•														

300  
400

PIGMA

Domestic Gas Boilers

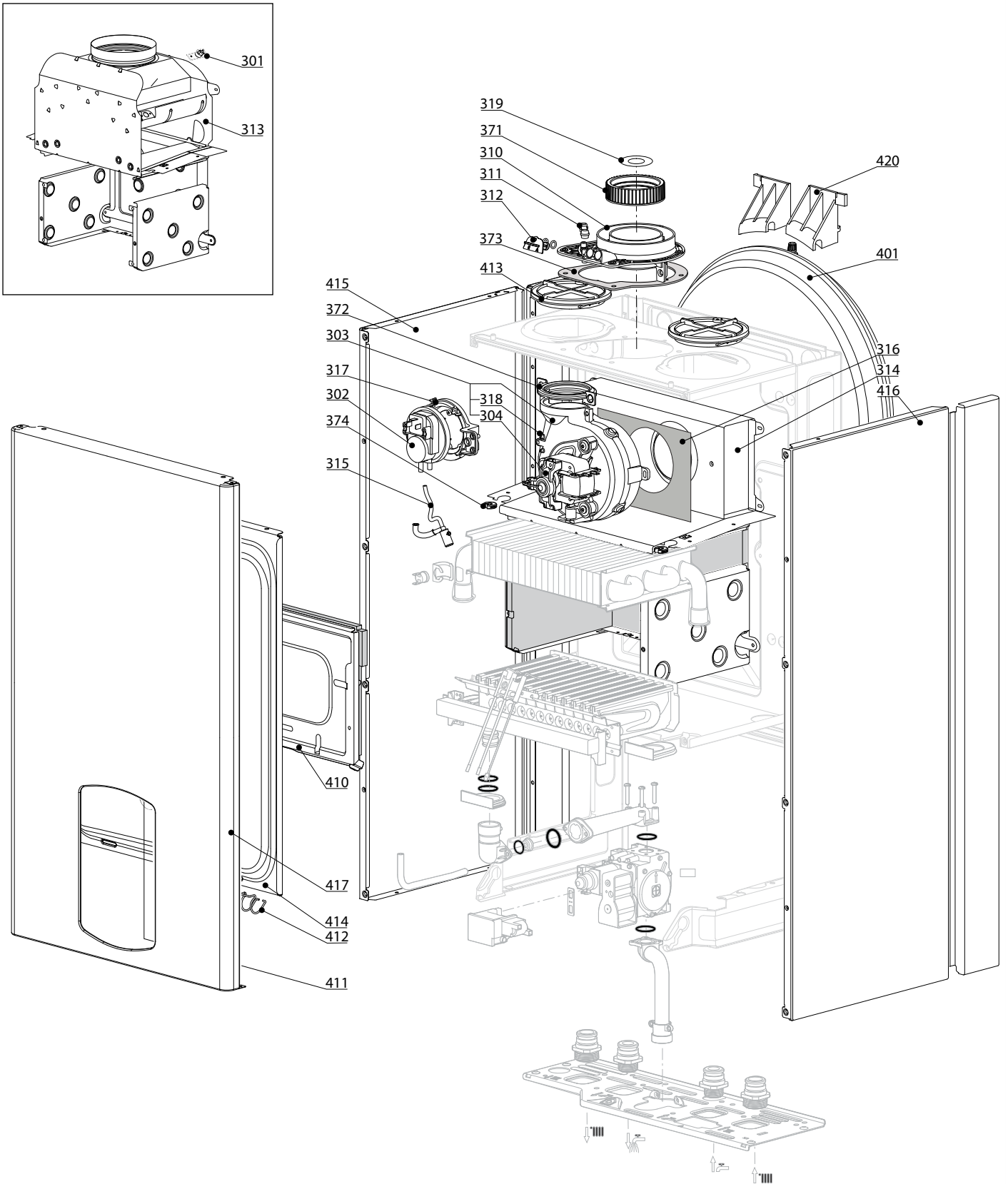

Description	Manf. Pt. N	Type	<div style="display: flex; justify-content: space-between; align-items: center;"> <div style="border: 1px solid black; padding: 2px;"> </div> <div style="text-align: center;"> <div style="border: 1px solid black; padding: 2px; transform: rotate(-45deg); display: inline-block;">           PIGMA 25 CF            PIGMA 25 VMC            PIGMA 25 FF            PIGMA 30 FF         </div> </div> <div style="border: 1px solid black; padding: 2px; text-align: center;">   <b>31</b> </div> </div>																			
			1	2	3	4	5	6	7	8	9	10	11	12	13	14	15	16	17	18		
<b>0300 FAN ASSEMBLY</b>																						
0301 OVERHEAT THERMOSTAT 49C	61310767			•																		
THERMOSTAT 75-65°C	999539			•																		
0302 AIR PRESSURE SWITCH 50 Pa	65104671-01				•																	
AIR PRESSURE SWITCH 74 Pa	65104672-01					•																
0303 FAN	65104357				•																	
FAN	65104452					•																
0310 FLUE (EXHAUST MANIFOLD / HEADER)	65105393				•	•																
0311 AIR INTAKE COVER	573329				•	•																
0312 FLUE INTAKE PLUG	65104295				•	•																
0313 COMBUSTION CHAMBER 24CF	65104218			•	•																	
0314 COMBUSTION CHAMBER 24/28 FF	65104219				•																02/08	
COMBUSTION CHAMBER 24/28 FF	65104219					•																
COMBUSTION CHAMBER 24/28 FF	65106295					•															03/08	
0315 CONDENSATE TRAP	65104623				•	•																
0316 PANEL (INSULATION - FAN)	65104305				•	•																
0317 SUPPORT (AIR PRESSURE SWITCH)	65104378				•	•																
0318 VENTURI 28/30FF	65106515					•																
VENTURI 15/24FF	65106516					•																
0319 RESTRICTOR KIT	60001598				•	•																
0371 COLLAR GASKET	65104258				•	•																
0372 FAN GASKET	65104257				•	•																
0373 GASKET	60000317				•	•																
0374 CABLE INLET RUBBER WASHER	60000716			•	•	•	•															
<b>0400 SEALED CASE</b>																						
0401 EXPANSION VESSEL	65104261			•	•	•	•															
0410 PANEL (COMBUSTION CHAMBER)	65104240				•																02/08	
PANEL (COMBUSTION CHAMBER)	65104240			•	•	•																
PANEL (COMBUSTION CHAMBER)	65106296				•																03/08	
0411 SIGHT GLASS	65104232				•	•																
0412 SPRING FRONT PANEL (KIT)	65104298				•	•																
0413 AIR RETURN COVER	65104249				•	•																
0414 PANEL (FRONT - SEALED CHAMBER)	65105678				•	•																
0415 CASE PANEL (L.H. SIDE)	65105676			•	•	•	•															
0416 CASE PANEL (R.H. SIDE)	65105677			•	•	•	•															
0417 CASE PANEL (FRONT)	60000983			•	•	•	•															
0420 EXPANSION VESSEL SUPPORT	65104696			•	•	•	•															

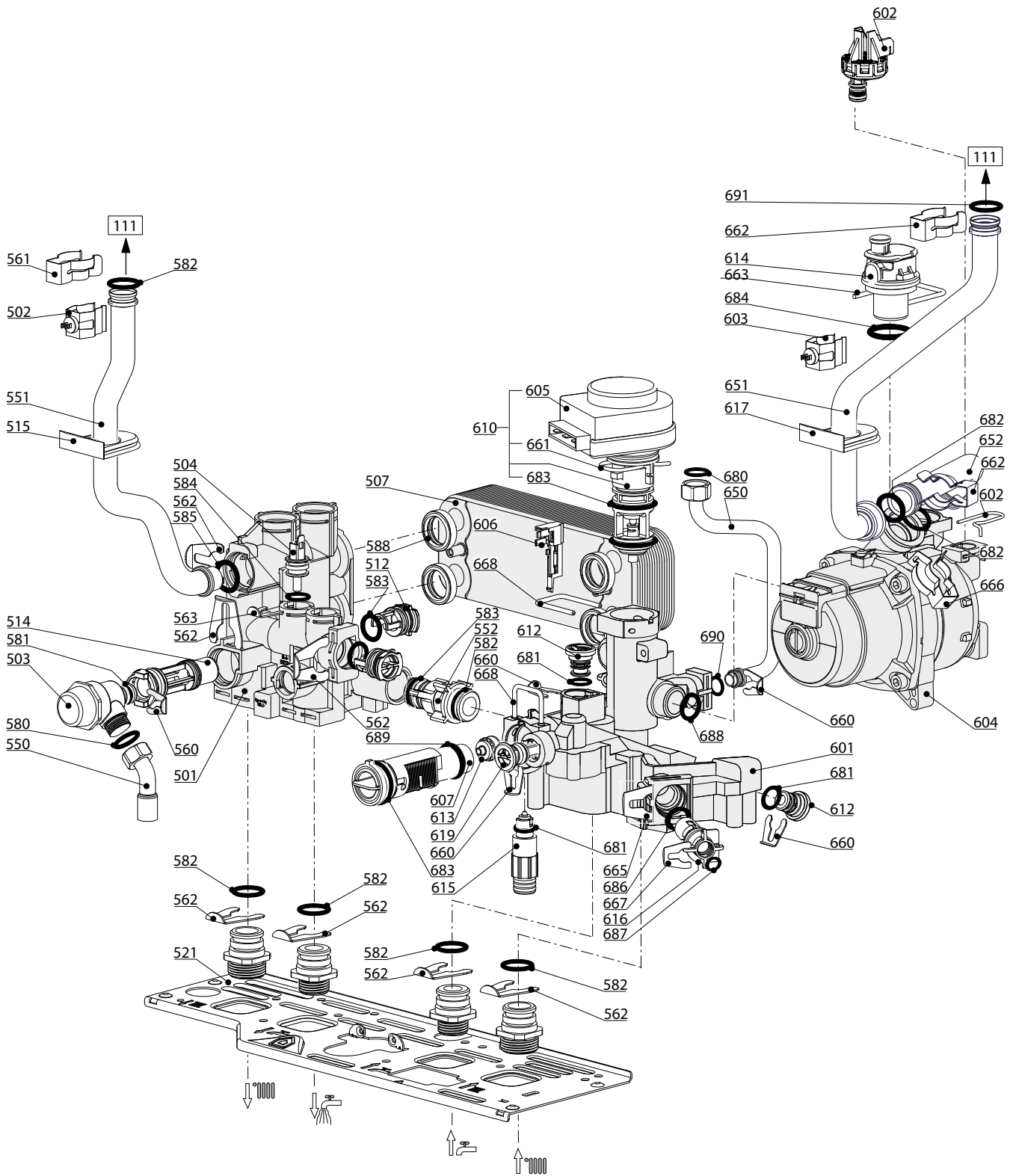



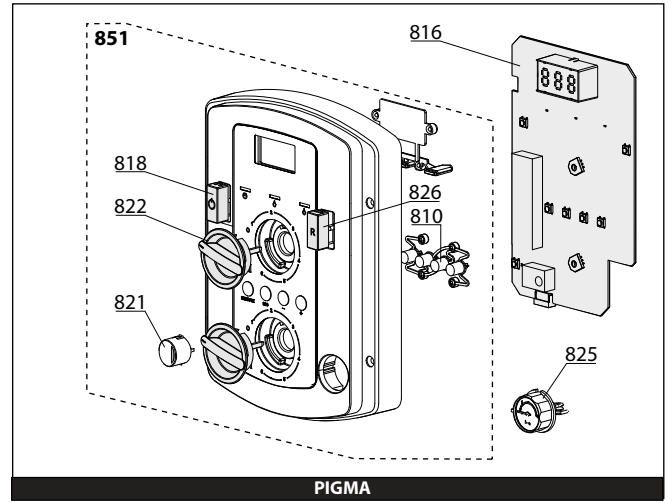
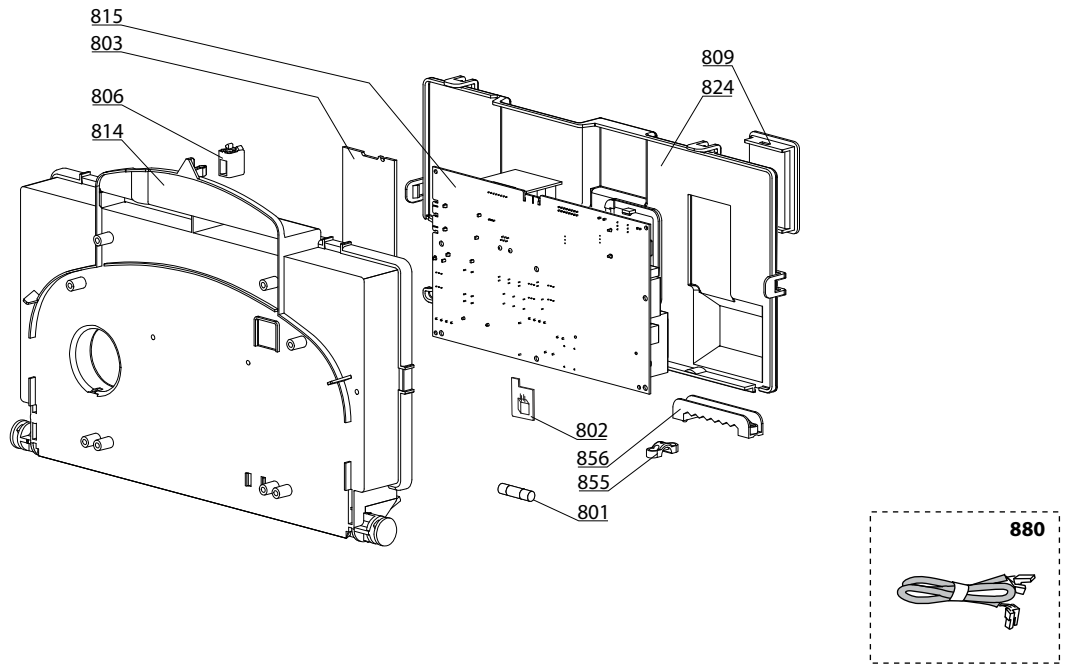

900

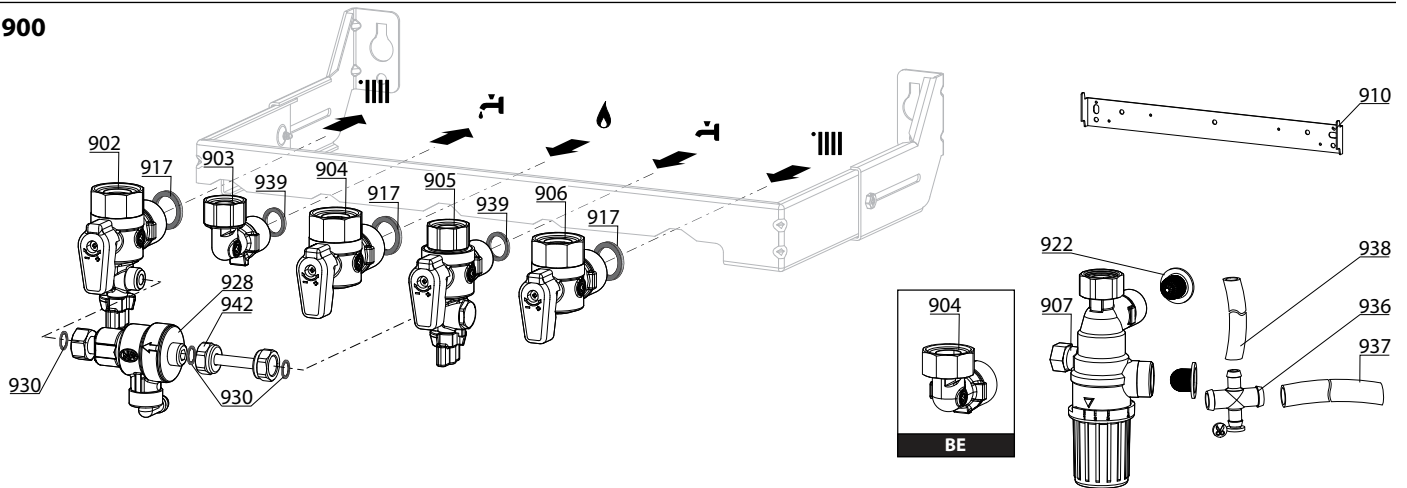

5000

**5001**  
 Transf. gaz > B/P  
 Conv. gas > LPG  
 Transf. gas > GPL  
 Transf. gas > B/P  
 Umrustsatz > B/P

**5002**  
 Transf. gaz > Nat  
 Conv. gas > Nat  
 Transf. gas > Met  
 Transf. gas > Met  
 Umrustsatz > Nat

**5020**  
 Options  
 Accessories  
 Opzioni  
 Accessorio  
 Option



☉⇒	Description	Manf. Pt. N	Type																			31
				1	2	3	4	5	6	7	8	9	10	11	12	13	14	15	16	17	18	
<b>0800</b>	<b>ELECTRICAL BOX</b>																					
0801	FUSE 250V 2A - TEMPORIZED	61003456		•	•	•	•															
0802	MODULE KIT (EEPROM)	65105148		•	•	•	•															
0803	P.C.B (CLIP-IN) E-BUS	65109108		•	•	•	•															
0806	PUSH	65104228		•	•	•	•															
0809	INSPECTION COVER	65104294		•	•	•	•															
0810	PUSH BUTTON	60000978		•	•	•	•															
0814	CONTROL PANEL	65104300		•	•	•	•															
0815	P.C.B. (MAIN)	65109313-02		•	•	•	•															
0816	PRINTED CIRCUIT BOARD (DISPLAY)	60000817-01		•	•	•	•															
0818	PUSH BUTTON ON/OFF	60000836		•	•	•	•															
0821	PUSH BUTTON	60000835		•	•	•	•															
0822	KNOB	60001003		•	•	•	•															
0824	CONTROL PANEL COVER (REAR)	65104293		•	•	•	•															
0825	PRESSURE GAUGE	60000725		•	•	•	•															
0826	BUTTON (RESET)	60000806		•	•	•	•															
0851	FRONT CONTROL PANEL COMPLETE	60000833		•	•	•	•															
0855	CABLE CLAMP	571562		•	•	•	•															
0856	CABLE CLAMP	65103377		•	•	•	•															
0880	EARTH WIRE	65104286		•	•	•	•															
	DISPLAY WIRING	60000746	/ CN02	•	•	•	•															
	NTC - PRES. SENSOR - GAS VALVE CABLE	60000840	/ CN04	•	•	•	•															
	IONIZATION ELECTRODE CABLE	65104518	/ CN05	•	•	•	•															
	SHUNT CABLE	60000839	/ CN07		•																	
	THREE WAY VALVE CABLE	65104523	/ CN09	•	•	•	•															
	PUMP 1V CABLE	65105081	/ CN10	•	•	•	•															
	FAN CABLE	65107270	/ CN10			•	•															
	CLIP-IN E-BUS WIRING	65105169	/ CN11	•	•	•	•															
	FLOW METER CABLE	60000813	/ CN14	•	•	•	•															
	FEEDER 240V	60000993	/ CN20	•	•	•	•															
	NTC - OVERHEAT THER. - PRES SWITCH CABLE	60000814	/ CN22			•	•															
	NTC PROBE - OVERHEAT THERMOSTAT CABLE	60000838	/ CN22		•																	
	ROOM THERMOSTAT CABLE	60000988	/ CN25	•	•	•	•															
	NTC PROBE - OVERHEAT THERMOSTAT CABLE	65104708	/ CN22	•																		
<b>0900</b>	<b>JIG PLATE &amp; PIPE FITTING</b>																					
0902	WATER FLOW SERVICE TAP	60000886		•	•	•	•															
0903	HOT WATER CONNECTION	60000891		•	•	•	•															
0904	GAS SERVICE TAP	60000898		•	•	•	•															
	UNION	65105631		•	•	•	•															
0905	COLD WATER TAP	60000894		•	•	•	•															
0906	WATER FLOW & RETURN SERVI. TAP	60000885		•	•	•	•															
0907	THERMOSTATIC MIXING VALVE	60001081		•	•	•	•															
0910	WALL HOOK	60000625		•	•	•	•															
0917	SHEET GASKET D: 24-17-1.5	60061855-19		•	•	•	•															
0922	FILTER	60001087		•	•	•	•															
0928	DISCONNECTOR	60000881		•	•	•	•															
0930	SHEET GASKET D: 11-5-1.5	60061853-07		•	•	•	•															
0936	UNION	60000879		•	•	•	•															
0937	TUBE PVC D: 13x17 L: 1M	60081266-02		•	•	•	•															
0938	TUBE PVC D: 9x12 L: 1M	60081266		•	•	•	•															
0939	SHEET GASKET D: 16.5-11-1.5	60061854-14		•	•	•	•															
0942	FILLER NECK	60001078		•	•	•	•															
<b>5000</b>	<b>ACCESSORIES</b>																					
5001	BURNER JET FULL KIT (LPG)	65104582					•															
	BURNER JET FULL KIT (LPG)	65106690		•		•																
5002	BURNER JET FULL KIT (NG) FR	65104585					•															
	BURNER JET FULL KIT (NG) FR	65106692		•		•																
5020	ROD PLATE	60000999		•	•	•	•															

## LIST OF THE ABBREVIATIONS

HW .....	: Hot water.
CW .....	: Cold water.
C .....	: Ceramic resistance (normal heating).
Ca .....	: Ceramic resistance (accelerated heating)
TP .....	: Immersion heater.
1F .....	: With fittings.
2F .....	: Without fittings.
3F .....	: With fittings and another outlet connection.
AMI .....	: With mixing valve.
SMI .....	: Without mixing valve.
PUISS .....	: Power of th appliance.
PN .....	: Appliance with normal pression.
LP .....	: Appliance with low pression.
PV .....	: Appliance with variable power.
PF .....	: Appliance with fixed power.

## IDENTIFICATION PLATE

### SERIAL NUMBER

<b>10 Characters :</b>	04 05 125 011	
	_____	Sequential number
	_____	Manufacturing day
	_____	Year of manufacture
<b>11 Characters :</b>	1 95 065004 - 31	
Month of manufacture :	_____	Technical number of the appliance
from 1 to 9 → Jan. to Sep.,	_____	Sequential number
O → Oct., N → Nov.,	_____	Year of manufacture
D → Dec.	_____	
<b>19 Characters :</b>	08 05 0013199 900640031	
Year of manufacture	_____	Product reference
Month of manufacture	_____	Sequential number
<b>20 Characters :</b>	3675007 XX 2 07 070 00315	
Product reference	_____	Sequential number
Millenium of manufacture	_____	Manufacturing day
	_____	Year of manufacture
<b>21 Characters :</b>	3675007 XX 07 070 0000315	
Product reference	_____	Sequential number
Year of manufacture	_____	Manufacturing day

The indications mentioned on the prices, commercial or technical literature and the scheme are written for your guidance and are available at a given time. The CONSTRUCTOR retains the power to modify the presentation, the form, the size, the conception or the material of the products.