

Atlantic Radiateurs & Eau Chaude Sanitaire

Produits

| Référence | Nom | Lettre |
|-----------|-----------------------|--------|
| 831405 | 2012 ETROIT 0500W BLC | A |

Paramètres

| Référence | Puissance(W) | Tension (V) | Capacité/Largeur | Couleur | Lettre |
|-----------|--------------|-------------|------------------|---------|--------|
| 831405 | 500 | 230 | 400 | BLANC | A |

6013A

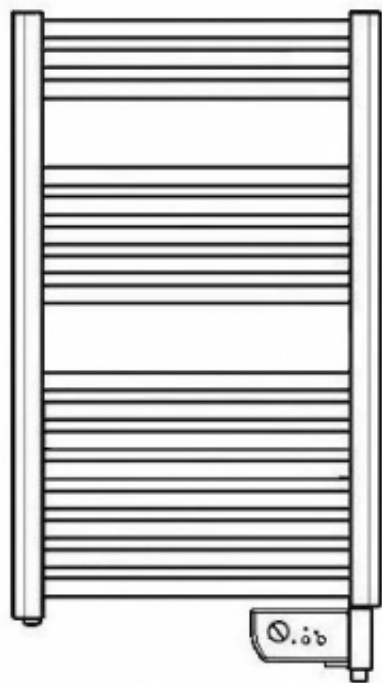

Version droite

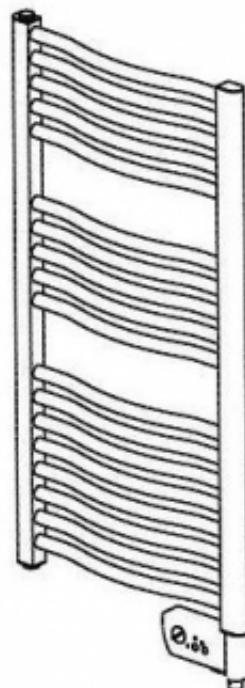

Version galbée
Avant 08.41

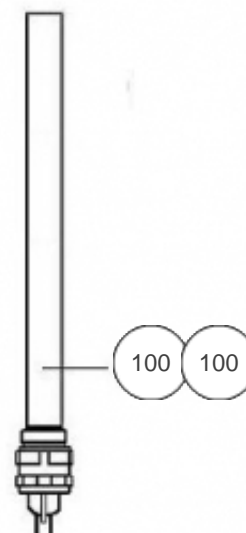
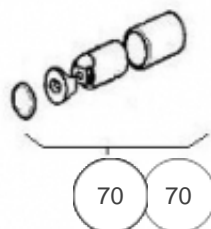
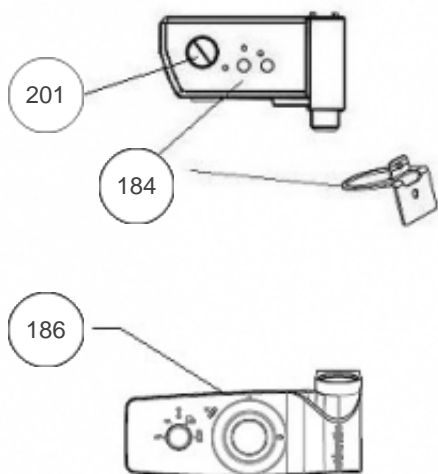

Références

| Repère | Libellé | A |
|--------|--|--------|
| 70 | KIT FIXATIONS MURALES (X4) <i>avant/before 1227</i> | 098173 |
| 70 | KIT FIXATIONS MURALES (X3) SFEG DROIT BL <i>depuis/since 1227</i> | 098797 |
| 100 | RESISTANCE 500W <i>avant/before 1146</i> | 086289 |
| 100 | RESISTANCE 500W SFEG <i>depuis/since 1146</i> | 086193 |
| 184 | BOITIER THERMOSTAT COMPLET <i>avant/before 1146</i> | 087752 |
| 186 | BOITIER THERMOSTAT CPT ATLANTIC <i>depuis/since 1146</i> | 087898 |
| 201 | MOLETTE THERMOSTAT SFEG1 <i>avant/before 1146</i> | 090061 |