

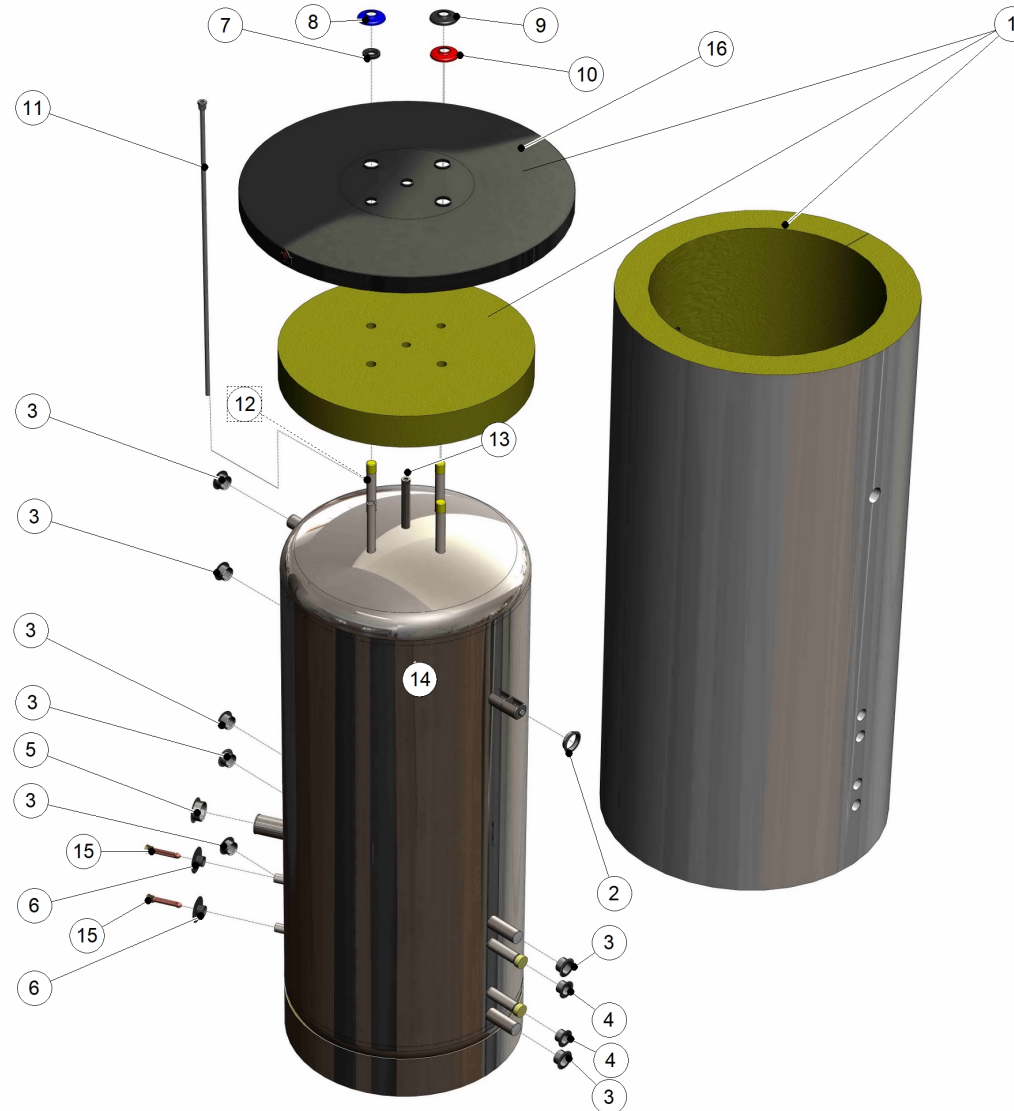









Smart ME 600 soft casing





## Smart ME 600 soft casing

Code	Code GA	Quant.	Photo	Description	De --- A ---	Remarque	
1	A1003497	787207	1		Kit Isolation Smart ME 600	01-10-16-	PREV 60772142
2	49410201	784903	1		Bague de retenue manchon 5/4		
3	49410069	784900	7		Bague de retenue manchon 4/4		
4	497B1039		2		Bague de fixation 3/4		
5	497B1026		1		Bague de fixation 6/4		
6	49410248		2		Bague reten Manch 1/2 (25,8) noir PVC		
7	557A0060	786585	1		Joint soufflet d:21 Dp:40		
8	497B1048	785876	1		Bague de retenue 3/4 bleue		
9	497B1050	785878	1		Bague de retenue 3/4 noire		
10	497B1049	785877	1		Bague de retenue 3/4 rouge		
11	39438046	784824	1		Doigt de gant inox 1/2x950		
12	497B0008	785853	1		Plonge PVCC 19,5x1140 perç.lat.		
13	55445006	785282	1		Purgeur air man.1/2		
14	A1003494		1		Corps emballé Smart ME 600	01-10-16-	PREV 27300548
15	63438001	785296	2		Doigt de gant laiton 1/2x100 3 bulbes		
16	A1002619	787007	1		Calotte sup. SLME600 soft jacket		